

Science & Innovation Parks and Campuses

in East Netherlands



Health

Food

Tech

Energy

East Netherlands
Development Agency

Colophon

Editor

East Netherlands Development Agency (Oost NL)

Editorial Board

Marlou Peet-de Bruin (Campus Nijmegen, Novitech Campus)

Mathijs Buddingh' (Campus Nijmegen, Lifeport Kenniscampus)

Janet den Hollander (Cleantech Park Arnhem)

Elleke Lieverdink (Connect-U)

Thijs van Dieren, Dennis van Huisum (Electricity Campus)

Debbie Brands (High Tech Systems Park)

Marius Woldberg, Adriaan Lok (Innovation District Spoorzone Zwolle)

Sjoerd Keijser (Perron038)

Marieke Vizee (Kennispark Twente)

Judith Reiber (Knowledge and Innovation Campus Zonneoord)

Hang Nguyen (NIZO Food Innovation Campus)

Bert ter Horst (Smartzone Deventer)

Marieke Vizee (Technology Base)

Rudy Horstman (The Green East)

Anne Mensink (Wageningen University & Research / Wageningen Campus)

David de Bruijn (World Food Center)

Dimitry Buter (XL Businesspark)

Design

.NLVK

Photography

Science & Innovation Parks and Campuses, Oost NL

© January 2026 East Netherlands Development Agency

Table of content

Preface	5
Our Science & Innovation Parks and Campuses	6
Facts & Figures	7
Parks & Campuses	
<i>Food Valley</i>	
Wageningen Campus	10
World Food Center	16
NIZO Food Innovation Campus	20
Knowledge and Innovation Campus Zonneoord	26
<i>Lifeport Region</i>	
Campus Nijmegen	32
Cleantech Park Arnhem	38
Electricity Campus	44

<i>Twente Region</i>	
Connect-U	50
High Tech Systems Park	56
Kennispark Twente	62
Technology Base	68
XL Businesspark	72
<i>Zwolle Region</i>	
Innovation District Spoorzone Zwolle	80
Smartzone Deventer	86
The Green East	92



Preface

Welcome to the East Netherlands!

The Netherlands is globally recognized as one of the most vibrant and innovative places for research and development. What truly sets our country apart is the way universities, research institutes, and private companies naturally collaborate — strongly supported by government initiatives. Together, they create the sustainable foods of the future, develop cutting-edge medical technologies that keep us healthy, and drive innovations for the energy transition, smart industry, and a circular, waste-free world.

East Netherlands is home to a remarkable concentration of world-class Science & Innovation Parks and Campuses. Here, innovative companies in agri-food, life sciences & health, high-tech, and smart energy find the ideal environment to grow, innovate, and make global impact.

We are Oost NL, the regional development agency for East Netherlands. We'd be delighted to connect you with the technology partners, ecosystems, and R&D facilities that matter for your organisation — and our services are completely free of charge.

Fons de Zeeuw

Director International



Our Science & Innovation Parks and Campuses

Science & Innovation Parks and Campuses in East Netherlands

Health

Kennispark Twente, Enschede (1)
 Campus Nijmegen (3)
 - Novitech Campus, Nijmegen
 - Lifeport Kenniscampus, Nijmegen
 Knowledge Campus Zonneoord, Ede (4)
 Connect-U, Enschede (16)

Food

Wageningen Campus, Wageningen (5)
 World Food Center, Ede (7)
 NIZO Food Innovation Campus, Ede (14)
 The Green East, Raalte (15)

Tech

Kennispark Twente, Enschede (1)
 Technology Base, Enschede (2)
 Campus Nijmegen (3)
 - Novitech Campus, Nijmegen
 - Lifeport Kenniscampus, Nijmegen
 Smartzone Deventer, Deventer (6)
 High Tech Systems Park, Hengelo (8)
 XL Businesspark, Almelo (12)
 Innovation District Spoorzone Zwolle / Perron038 (13)
 Connect-U, Enschede (16)

Energy

Cleantech Park Arnhem / Connectr, Arnhem (9)
 Electricity Campus, Arnhem (10)
 Innofase, Duiven (11)



Facts & Figures

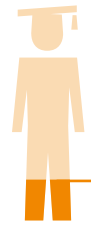

3.35 million inhabitants
18,6% of the Dutch population
(CBS, 2025)

3

Research Universities

11

Universities of Applied Sciences

25

Vocational schools

No. of students > 231,500 (CBS, 2025)

Primary sectors:



Food



Health



Tech



Energy



In 2024 more than

4,250

companies from East Netherlands use a Dutch financial R&D incentive called WBSO (22% of all Dutch companies using the WBSO) with a total value of over € 1.5 billion. This amount benefits R&D activities.

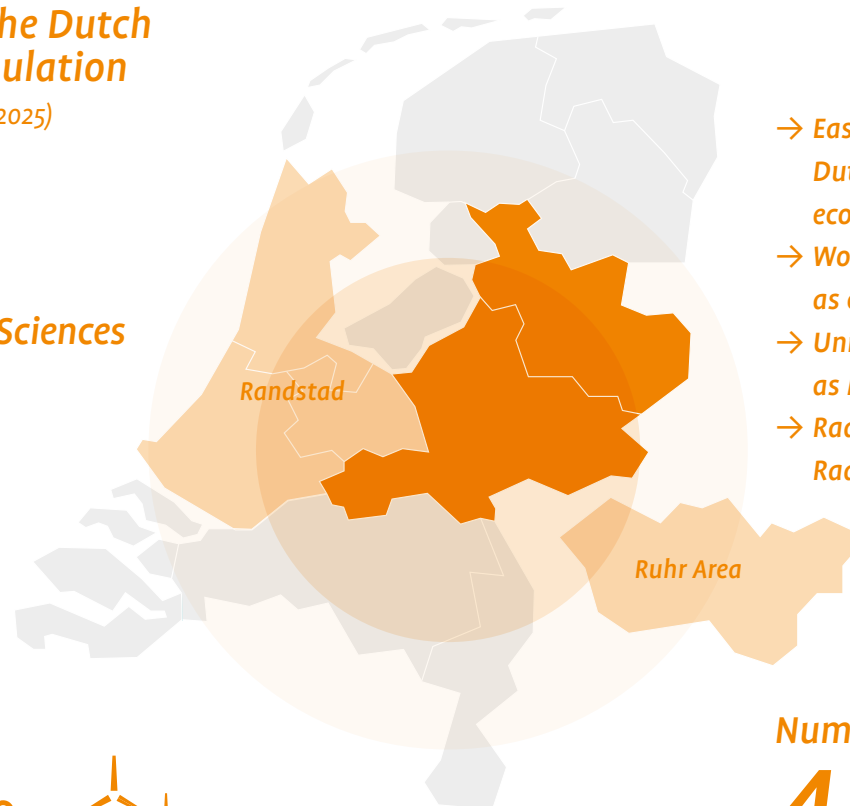

- East Netherlands is right in between Dutch Randstad and German Ruhr Area economic powerhouses
- World leading Agrifood University of Wageningen as core of Foodvalley region
- University of Twente with leading institutes such as MESA+, the core of MedTech research
- Radboud University with university medical center Radboudumc

Number of Companies

430,000 (CBS, 2025)

Number of top knowledge institutes

>40

Food Valley

Food Valley

Food Valley is well-known for its remarkable developments in agri-food innovation. One of the reasons for its success is its multifaceted approach to solving global challenges. It is the interconnected network of innovative start-ups and scale-ups, larger corporates, government organisations, research institutes, universities and NGOs that provide the region with the knowledge, resources and capacity for cooperation which make the region what it's known for today.

Food Valley is home to world-class research institutes that progress our knowledge and understanding. At the centre lies Wageningen University & Research (WUR), which leads developments in agri-food technology, nutrition, and sustainability.

Science & Innovation Parks and Campuses in Food Valley

Food

World Food Center, Ede (5)

Wageningen Campus, Wageningen (7)

NIZO Food Innovation Park, Ede (14)

Health

Knowledge Campus Zonneoord, Ede (4)

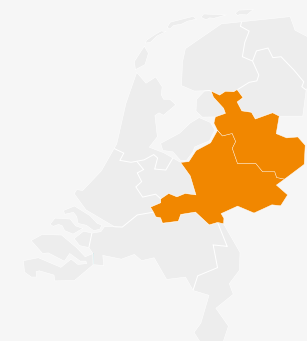

Wageningen Campus

An aerial photograph of the Wageningen Campus, showing a mix of modern academic buildings, green spaces, and a large sports field. The campus is surrounded by trees and greenery, with a road and parking areas visible. The sky is clear and blue.

@Rob Goossens

Profile

Wageningen Campus is designed to be a vibrant meeting place for scientists and researchers from 13 research institutes, Wageningen University, start-ups, SMEs, R&D centers of national and international companies, and approximately 16,000 students. All working in the fields of nutrition, agro-and food production, life- and health sciences, biobased products, AI and the living environment.

Infrastructure

Railway stations

- > Ede-Wageningen
5.5 km - 10 min by bus
- > Arnhem (ICE train)
30 min by public transport

Airports

- > Amsterdam Airport Schiphol
90 km - 1 hr by car, 1 hr 30 min by bus/train
- > Eindhoven Airport
83 km - 1 hr by car
- > Düsseldorf Weeze
81 km - 1 hr by car
- > Düsseldorf Int. Airport
141 km - 1 hr 30 min by car

Motorway

- > A12
3.2 km - 5 min by car

Digital infrastructure

- > World-class, located in one of the best fiber optic networks in the world, SURFnet, with SURFnet POP. Prepared for 5G, with high capacity redundant electricity infrastructure up to 10 MVA

Wageningen City Center

- > 1.5 km - 5 min by bicycle

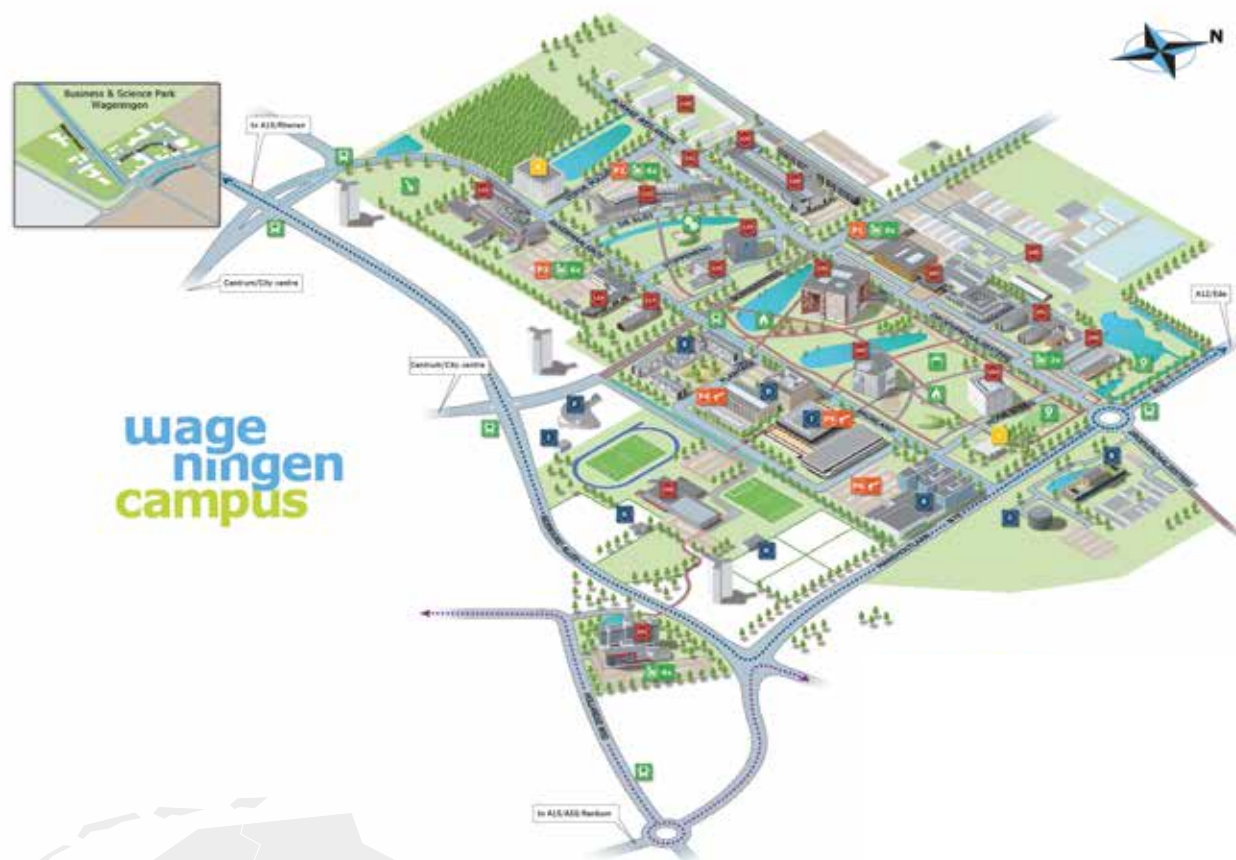

wageningen
campus

Area

1,050,000 m²

Building capacity

710,000 m²

Development space

100,000 m²

Organizations

>240

Jobs

8,000

Students

>16,000



Wageningen

Wageningen Campus

Long-term Vision

The following strategic goals have been defined in order to take the next step in campus development and to remain the world-leading campus in our domain:

> Strategic acquisition

Investing in a future-proof campus organisation, capable of proactive and strategic acquisition, with sufficient people and means.

> Increasing accessible and affordable research and innovation facilities

Investing in well-equipped, affordable (shared) research facilities to maintain the appeal for Wageningen Campus as innovation hub.

> Stimulating interaction and cooperation between campus residents

Taking advantage of the great willingness of parties to develop inspiring programmes and meeting points,



Wageningen University with approximately 16,000 students from over 100 nationalities. Worldwide, the number 1 university in Agriculture & Forestry (QS World University Rankings 2024).



Wageningen Unifarm, with advanced NPEC phenotyping- and greenhouse facilities and experimental fields for crop research.

accelerating knowledge sharing, innovation and encounters with students.

> Further developing Wageningen Campus Oost and Wageningen Campus West and ensuring better physical connection.

> Accelerating energy transition

Investing in sustainable energy generation and efficient energy distribution.

> Improving accessibility

Realising improvements in the accessibility by bicycle, car and public transport.

Open Innovation Strategy

On Wageningen Campus, we know that sharing knowledge is as important as developing knowledge, convinced as we are that this is the key to truly innovative solutions to the global challenges of our time. This is why Wageningen Campus is designed to be a meeting place for researchers, students, entrepreneurs, SMEs, and research centers

Wageningen Campus is designed to be a vibrant meeting place for scientists and researchers from 13 research institutes, Wageningen University, start-ups, SMEs, R&D centers of national and international companies, and approximately 16,000 students.

of corporates in the fields of nutrition, health, AI, food production and the living environment. On Wageningen Campus, the academic world, the business sector and the government collaborate to address today's major social issues: the world food need, the growing pressure on blue and green spaces, the demand for sustainable production, the desperate need for alternatives to fossil fuels and the impact of climate change.

These issues are interrelated and must be addressed in conjunction with each other. As a result, these issues are ideally suited to be studied on Wageningen Campus.

World-class Research Institutes

- > Wageningen University
- > Wageningen Research
 - Wageningen Bioveterinary Research
 - Wageningen Environmental Research
 - Wageningen Food & Biobased Research
 - Wageningen Food Safety Research
 - Wageningen Livestock Research
 - Wageningen Marine Research
 - Wageningen Plant Research
 - Wageningen Social & Economic Research
- > NIOO-KNAW
- > MARIN
- > OnePlanet Research Center
- > Jan IngenHousz Institute

R&D Focus

(well aligned with the National Technology Strategy (NTS) and the key enabling technologies)

- > Global Health;
- > Sustainable Food Systems;
- > Biobased and circular society;
- > Sustainable water and land use;
- > Biodiversity and resilient ecosystems;
- > Climate-proof futures.

Shared R&D Facilities

Shared Research Facilities, part of Wageningen University & Research (WUR), allows researchers from all organizations, whether from universities, research institutes or

companies, to use advanced research equipment housed by WUR and other R&D organizations on Wageningen Campus. Research facilities range from a (shared) Food Innovation Kitchen to advanced research facilities at laboratory scale to state-of-the-art facilities for high performance computing, pilot-scale biorefinery, food conversion, climate rooms, greenhouses, aquatic research facilities, food-and/or biotech facilities and experimental fields for crop research at, for example, Unifarm, The Netherlands Plant Eco-phenotyping Centre (NPEC), Phenomea, AlgaePARC, UNLOCK, Cibia Food Tech Facility and the Wageningen Data Competence Center.



© Joris Schaap

Wageningen Campus

Start-up Facilities and Programs

Wageningen Campus has a flourishing entrepreneur community where new ideas and initiatives in the field of food & agrotechnology originate. The campus facilitates entrepreneurs with flexible housing opportunities, support, coaching, and pre-seed capital. Forms of support vary from educational activities for university students in the StartHub, a complete range of network contacts and experts for Ag-Tech entrepreneurs or seed capital via StartLife, to location options in an incubator at, for instance, Plus Ultra II or in one of the private incubators, such as BOX (Blue Ocean XLerator).

Sustainability

Our policy

Mission: 'To explore the potential of nature to improve the quality of life' and remain a leader in terms of sustainable operational management. Policies are aimed at creating a circular economy and climate neutrality. Our campus features numerous examples of sustainable construction, energy efficiency and innovations in a green environment.

Our main objectives

- > Construct and furnish buildings as sustainably and circular as possible;
- > Use green electricity and refrain from using natural gas;
- > Generate renewable energy: augment the heat exchange system and increase use of solar energy on campus.

Remarkable sustainability achievements

- > The Netherlands Institute of Ecology - Royal Dutch Academy of Sciences (NIOO-KNAW) building is based on the cradle to cradle philosophy and has won many awards. It includes an award-winning green roof 2.0,

plants providing power, and water treatment technology;

- > Plus Ultra building I: won the architectural ARC16 Detail Award in 2016. Plus Ultra II has been rewarded with the BREEAM-NL EXCELLENT certificate. Plus Ultra III is a building made almost entirely of wood and is constructed in a CO₂-negative manner and has a BREEAM Excellent certificate;
- > Unilever Global Foods Innovation Center: Building Research Establishment Environmental Assessment Method (BREEAM) Global Design Award and the Global Public Award in 2019;
- > The Flora Food Group Food Science Center has been certified as BREEAM Outstanding;
- > Wageningen University & Research uses an aquifer thermal energy storage (ATES) beneath Wageningen Campus;
- > In December 2025, Wageningen University & Research ranked first in the worldwide GreenMetric ranking for the ninth consecutive year (most sustainable university in the world). WUR also ranked highest in the categories of waste management and water management.



Aquatic research

Community Services & Facilities

Wageningen Campus has several facility buildings incorporated in Campus Plaza (1,000 m²) including restaurant and catering facilities, supermarket, coffee bar and bakery, as well as six restaurants and some kiosks in Wageningen University & Research buildings that are accessible to the public. The restaurants of Aeres University of Applied Sciences and Unilever are open for everyone too.

Wageningen Campus organises a number of programs for the campus community (for example Wageningen Dialogues, Summervibes festival, Campus Connect meetings, Wageningen Campus Expeditions as well as cultural programs with lunch concerts, theatre, dance and sports activities) and facilitates events such as F&A Next. For meetings, Wageningen Campus can provide formal and informal meeting and/or debating locations, such as dialogue center Omnia, meeting center Impulse and the outdoor amphitheatre.

Leisure

Indoor & outdoor sports facilities, ca. 10,000 m². Weekly cultural program, exhibitions, pop-up activities.

Parking

Main parking route, 4 green parking garages.

Park management

- > Site- and building-related services.
- > Campus catering, high quality green maintenance, waste management.

Governance

Campus ownership

- > Wageningen University & Research /multiple private owners.

Decision makers/decision-making process & management

- > University site: Wageningen University & Research (both initial point of contact for interested companies, contracts and management).
- > Business & Science Park Wageningen: multiple private owners, BSPW organization.

Commitment & support

Wageningen University & Research, Municipality of Wageningen, Province of Gelderland, Oost NL, NIOO-KNAW, Aeres University of Applied Sciences, Business & Science Park Wageningen (BSPW), Foodvalley NL, StartLife, Next Food Collective.

Buildings

Education and Research	ca. 320,000 m ²
Company buildings	ca. 210,000 m ²
Housing (students)	ca. 80,000 m ²
> On campus (incl. BSPW)	2,350 units
> Off campus (excl. private market)	6,000 units

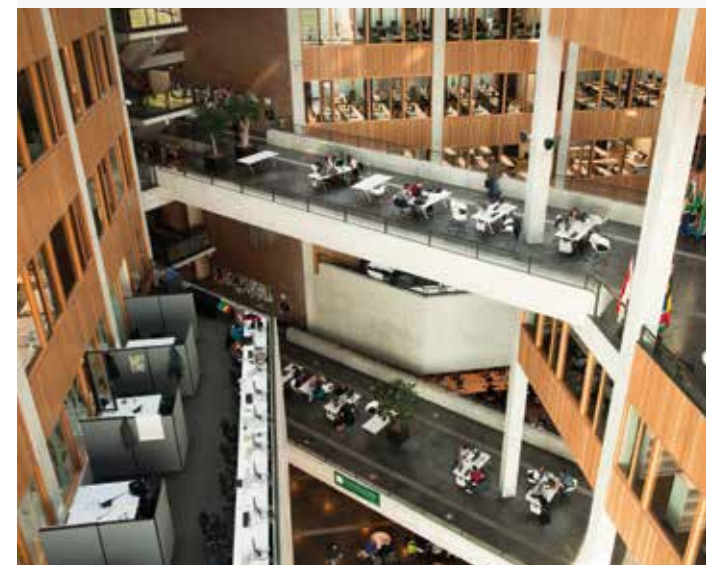

© Joris Schaap



Contact

Wageningen Campus

Anne Mensink

Manager Campus & Facilities team

Plus Ultra II, Bronland 10

6708 WH Wageningen

T: +31 317 48 10 52

info@wageningencampus.nl | wageningencampus.nl

World Food Center



Profile

Everything revolves around agri and food at the World Food Center: the ultimate agri and food meeting place in the Netherlands. On the edge of the Veluwe, a dynamic new urban district is emerging at the former barracks site in Ede, where people live, work and experience. It is where we are creating an optimal and high-potential business climate for innovative (agri)food businesses, organizations and knowledge institutions who strive to work together on a healthy future for people, planet and profit: We Work Food.

Infrastructure

Railway station

- > Ede-Wageningen
0 km

Airports

- > Schiphol
90 km - 60 min by car
- > Rotterdam The Hague
100 km - 1 hr 15 min by car
- > Eindhoven
86 km - 1 hr 5 min by car
- > Weeze
85 km - 1 hr 10 min by car

Motorways

- > A12: 4 km - 6 min by car
- > A30: 7,5 km - 9 min by car

Digital infrastructure

- > Glass fiber, Wi-Fi and Park fully broadband

City Center

- > Ede: 7 min by bus - 5 min by car - 15 min by bicycle
- > Wageningen: 10 min by bus - 10 min by car - 15 min by bicycle
- > Arnhem: 12 min by train - 35 min by bus - 25 min by car
- > Utrecht: 24 min by train - 50 min by bus - 41 min by car
- > Amsterdam: 53 min by train - 75 min by bus - 41 min by car
- > The Hague: 69 min by train - 90 min by bus - 72 min by car



Area

280,000 m²

Building capacity

15,400 m²

Development space

50,000 m²

Companies

80

Jobs

500



World Food Center

Long-term Vision

The former Maurits Zuid barracks in Ede are transformed into the ultimate agri and food meeting place in the Netherlands – the heart of the Foodvalley region, with Wageningen University & Research just a stone's throw away. It's a vibrant hub where innovation, entrepreneurship, and cutting-edge research come together to shape the future of food.

The World Food Center is where new products, concepts and services are developed, tested and marketed. As a result, the efforts related to solving our food problems also bring plenty of economic opportunities.

Open Innovation Strategy

We strive for profit on all fronts. We work together to achieve financially healthy businesses as well as a sustainable future for food. Anyone who (in)directly contributes to a healthier and more sustainable food system is welcome to establish themselves here, whether you're from the agriculture and food industry, or health, tech, finance or HR. The World Food Center is the perfect microclimate for businesses and organizations from any segment of the food industry. From start- this inspiring environment connects businesses, business service providers, trade associations, knowledge institutions and educational institutes.

There are short lines to various renowned educational and research institutes, so that businesses at the World Food Center can count on a hive of young talent and experienced professionals. The World Food Center offers talents an amazing environment to grow. Who wouldn't want to work in a place as inspiring as this? The Veluwe's expansive

nature as a backdrop and the former barracks as a reminder of a rich past.

Start-up Facilities

ROOTS Innovation Hub offers affordable business premises and flexible terms. Over 50 start-ups and scales-ups have settled in the former barracks of ROOTS. With the presence of various renowned educational and research institutes, and the connection with the World Food Center community network, ROOTS offers a great environment for start-ups to grow their dreams and businesses.

FoodX

FoodX is the gateway to connect with new ideas, solutions and partnerships from the Dutch agri-food sector. FoodX organizes and facilitates meetings between parties in

search of partnerships focused on food system transitions. They do this from our inspiring venue at the World Food Center in Ede, where they connect innovators from all over the Netherlands and far beyond.

Sustainability

World Food Center has a durability vision policy. In the development of new office buildings, sustainable materials and energy systems are used. The location encourage new-mobility solutions; shared cars, public transportation, electrical vehicles and charging points.

The area is developed with great care for nature. The location is adjacent to the biggest national park of The Netherlands called the Veluwe.



Community Services & Facilities

The World Food Center offers a unique surrounding with the Veluwe's expansive nature as a backdrop and the former barracks as a reminder of a rich past. All this serves to create an appealing, vibrant work environment that attracts new generations like Millennials & Gen Z. the green surroundings are embraced in the architecture and interwoven with public spaces.

Leisure

Several indoor and outdoor event locations for congresses, meetings or festivals.

Parking

Wide range of free parking spaces.

Park management

In the near future there is the following planned:
Park restaurant, Hotel/congress, Gym, Child daycare, Convenience store, outdoor activities.

Creating an optimal and high-potential business climate for innovative (agri)food businesses, organizations and knowledge institutions who strive to work together on a healthy future for people, planet and profit: We Work Food.

Building related services

- > Cleaning
- > Maintenance

Governance

The World Food Center area is being developed by the Ede municipality and WFC Development B.V., a collaboration between BPD (Bouwfonds Property Development), Green Real Estate B.V. and Van Wijnen Groep N.V.

Company buildings

- > The Friso building 6,000 m²
- > The Maurits building 6,000 m²
- > The new office development on lot C 7,000 m²
- > ROOTS Innovation Hub 3,400 m²

@Nina Slagmolen



WORLD
FOOD
CENTER

*We feed
each other*

Contact

World Food Center
Louis de Boer | Sander van de Pol
accountmanagers

Frisopark 4
6711 WZ Ede
T: +31 6 54 75 44 88 | +31 318 68 00 26
info@worldfoodcenter.nl | worldfoodcenter.nl



NIZO Food Innovation Campus

Profile

Located in the heart of the Netherlands' Food Valley, Food Innovation Campus at the site of NIZO food research offers a unique blend of expertise, technology, scaling-up facilities and networking to accelerate your innovation in food.

Gain direct access to Europe's largest open-access & food-grade pilot plant, with laboratories, offices, and 100+ leading experts ready to support you in protein technology, fermentation and precision fermentation, bioinformatics, health, food processing, food safety and sensory science. Beyond facilities and know-how, you are at the center of a vibrant network of experts, partners, and stakeholders across the Netherlands and Europe.

1. Office & laboratory space
2. Office & laboratory space
3. NIZO Pilot Plant
4. BFF Pilot Plant
5. NIZO Lactic Acid Facility
6. Commercial Pilot Plant
7. Indoor & outdoor canteen



Area

42,480 m²

Building capacity

11,000 m²

Companies

>10

Jobs

>150

Students

>10

NIZO Food Innovation Campus

Infrastructure

Railway stations

- > Ede-Wageningen
6 km - 20 min by bus

Airports

- > Amsterdam Airport Schiphol
89 km - 1 hr by car
- > Eindhoven Airport
95 km - 1 hr 10 min by car
- > Airport Weeze
93 km - 1 hr 15 min by car
- > Rotterdam The Hague Airport
100 km - 1 hr 15 min by car

Motorway

- > A30: 3 km - 6 min by car
- > A12: 6 km - 8 min by car
- > A1: 17 km - 15 min by car
- > A50: 18 km - 15 min by car

Digital infrastructure

- > Fiber, WI-FI, Fully broadband on request

City Center

- > Ede: 5 min by car - 10 min by bicycle
- > Wageningen: 20 min by bus - 10 min by car - 15 min by bicycle
- > Arnhem: 40 min by train - 40 min by bus - 20 min by car
- > Nijmegen: 1 hr by train - 1 hr by bus - 40 min by car

NIZO Food Innovation Campus

Long-term Vision

The NIZO Food Innovation Campus is the place where start-ups, scale-ups, corporates and knowledge institutions work side by side on the future of sustainable proteins and the broader food transition. With high-quality, open-access facilities, including Europe's largest food-grade pilot plant and the new Biotechnology Fermentation Factory (BFF), the campus is developing into the European hub for protein innovation and the upscaling of new, sustainable food ingredients and food products.

Open Innovation Strategy

Progress in food innovation comes through sharing knowledge, scaling-up facilities, expertise, and creating a smooth path for start-ups and food companies to successfully accelerate their innovations. The NIZO Food Innovation Campus aligns seamlessly and synergistically with other agri-food hubs, collectively strengthening the entire region's innovation and growth.



Food application center



NIZO Food Innovation Campus in Ede focuses on the higher TRL levels in the innovation journey: testing, scaling up and preparing innovations (prototypes and end products) for the market, in collaboration with industry.

The NIZO Food Innovation Campus together with the Wageningen Campus and the Food Innovation District near Ede railway station, form a strong triangle where knowledge, research, entrepreneurship and market introduction reinforce each other, further positioning the FoodValley Region on the international map.

World-class Research Institutes

NIZO food research – a globally leading private and independent contract research and manufacturing organisation with 75+ years of expertise in food and health innovation.

The NIZO Food Innovation Campus is the place where start-ups, scale-ups, corporates and knowledge institutions work side by side on the future of sustainable proteins and the broader food transition.

R&D Focus

The NIZO Food Innovation Campus focuses on enabling food products and ingredients to reach the market and the consumer, contributing to a sustainable and secure global food supply. We follow an integrated approach across the full product development cycle, with key focus areas:

- > Protein transition & Upcycling
- > Sustainable processing and upscaling
- > Fermentation & Precision Fermentation
- > Health & Nutrition
- > Sensory
- > Food Safety & Chain Control
- > AI & Data Science

Shared R&D Facilities

- > NIZO Food Application Centre – a fully equipped professional kitchen and customisable workspace for ingredient and end-product preparation.
- > NIZO Pilot Plant - Europe's largest open-access & food-grade pilot plant, enabling testing and upscaling.
- > Biotechnology Fermentation Factory – Europe's first open-access, food-grade validation hub for fermentation-based food innovations.

Start-up Facilities and Programs

The NIZO Food Innovation Campus provides offices, laboratories, and shared R&D facilities, combined with validation opportunities and expert guidance to bring start-up concepts quicker to market.

We support access to funding and investor connections. We assist in setting up pre-competitive consortia and help secure subsidies and vouchers through expert guidance, leveraging our extensive experience.

In addition, we set up public-private partnerships aimed at developing relevant knowledge and technologies where start-ups, established companies and knowledge providers work together.

Sustainability

Together with partners in Ede and the FoodValley Region, the NIZO Food Innovation Campus is building a future in which sustainable proteins and innovative food solutions put not only the region, but also the Netherlands and Europe, firmly on the international stage. The campus will serve as the hub where ideas grow into impactful innovations that contribute to a healthy and sustainable food system.

Our main objectives

We work towards sustainable food ingredients and global food security by turning novel and underutilized protein sources into safe, consumer-ready food products. In order to do so, researching new protein sources in the laboratory is not enough, it is crucial to test and develop them using scalable processes into safe and edible products. Proteins are indispensable in our diet; they are the building blocks for muscles, recovery and energy. Until now, proteins have mainly been sourced from meat, fish, eggs and dairy, but this requires significant amounts of farmland, water and energy. That is why there is a growing need for new, more sustainable sources of protein, such as plants, algae and fermentation (biomass). The facilities and know-how that lie in the NIZO Food Innovation Campus will make sure this can be realized.



NIZO pilot plant

NIZO Food Innovation Campus

Community Services & Facilities

You enjoy easy access to shared R&D facilities at the campus, while being only steps away from green spaces and walking paths. On site, you will find an indoor/outdoor restaurant with catering, coffee & tea spots, and fully equipped conference rooms (10 – 150 people). The campus is surrounded by leisure, cultural, and outdoor options in the Ede region.

Leisure

Indoor and outdoor meeting and congress locations.

Parking

Ample parking available.

Park management

> Site-related services:

- > 6 EV charging points
- > 24/7 security
- > Central reception
- > Site management
- > Waste management
- > Green maintenance
- > Technical services

> Building-related services:

- > Open-access food-grade pilot plant
- > Open-access food-grade food application center
- > Lab space
- > Offices
- > Meeting rooms
- > Restaurant & catering
- > Copy & print facilities
- > Lactation room
- > Cleaning service



Governance

The NIZO Food Innovation Campus is being developed by NIZO Food Research, Gilde Healthcare and Oost NL.

Commitment

The NIZO Food Innovation Campus is initiated and jointly supported by NIZO Food Research, the Province of Gelderland, the Municipality of Ede, the FoodValley Region and Oost NL, working together to foster a leading and dynamic ecosystem.

Buildings

Education and Research	6,200 m ²
Company buildings	3,650 m ²



NIZO Food Innovation Campus



Contact

NIZO Food Innovation Campus
Dr. René Floris
Chief Innovation Officer

Kernhemseweg 2
6718 ZB Ede
T: +31 318 65 95 11
info@foodinnovationcampus.com
www.foodinnovationcampus.com



Knowledge and Innovation Campus Zonneoord

Profile

Knowledge and Innovation Campus Zonneoord is a country estate in Ede where health, knowledge, innovation and nature come together. This combination makes us a unique place to work and meet. For meetings, events or just the daily business.

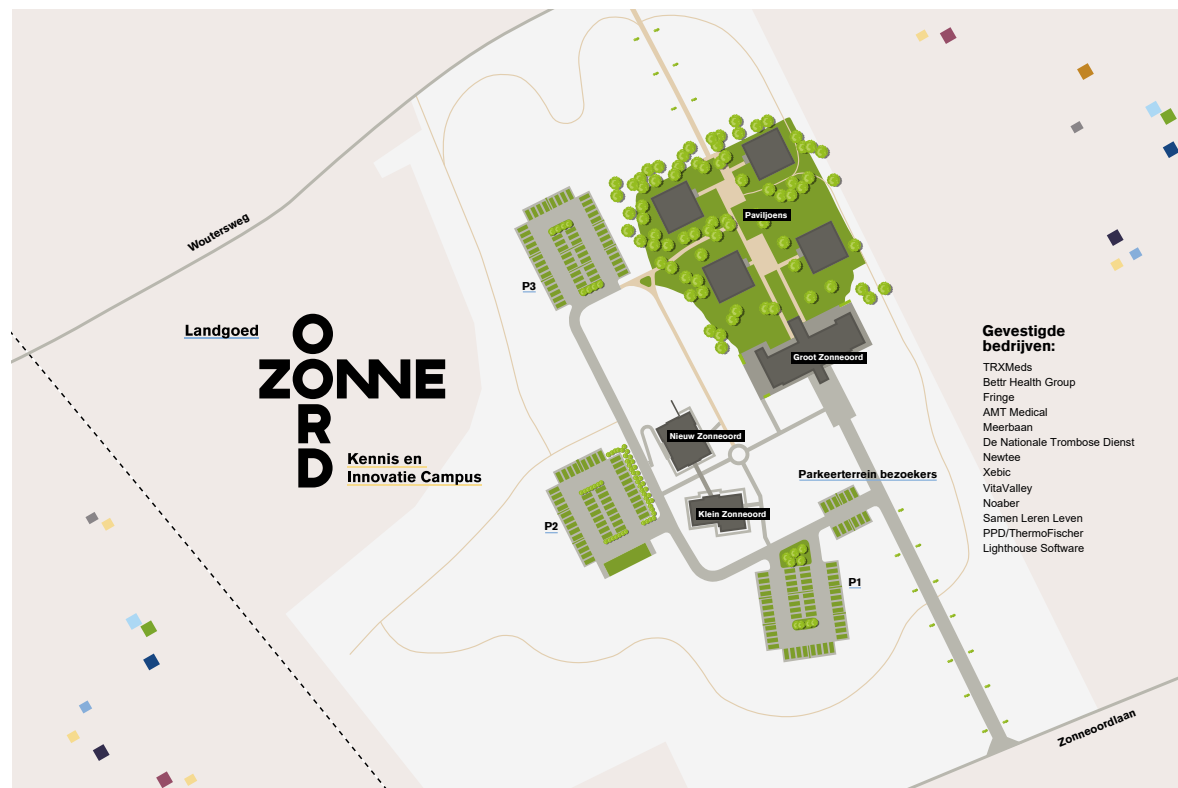

Infrastructure

Railway stations

- > Ede-Wageningen
5.3 km - 10 min by car
- > Lunteren
3.5 km - 5 min by car

Airports

- > Schiphol
85 km - 58 min by car
- > Dusseldorf Flughafen
143 km - 1 hr 30 min by car

Motorways

- > A1
15.6 km - 15 min by car
- > A12
10,6 km - 12 min by car
- > A30
3,9 km - 6 min by car

Digital infrastructure

- > Glass fiber, Wi-Fi are present.
Broadband on request.

City Center

- > Ede: 15 min by bus - 7 min by car - 10 min by bicycle
- > Arnhem: 32 min by train - 77 min by bus - 28 min by car - 65 min by bicycle
- > Amersfoort: 32 min by train - 60 min by bus - 30 min by car - 88 min by bicycle



Area
60,000 m²
Building capacity
6,000 m²

Companies
15
Jobs
250

Knowledge and Innovation Campus Zonneoord

Long-term Vision

Contributing to a positive healthy society. We house and facilitate companies and organizations that, like us, are working towards a natural and healthier society. Because they are active in the healthcare sector, develop new technologies in the field of health, or simply value innovation, cooperation and vitality.

Open Innovation Strategy

We work together on innovation strategies and facilitate exchange of knowledge and experiences.

Shared R&D Facilities

The Estate has a fully equipped cleanroom of 55 square meters with 6 workstations.



Start-up Facilities

One of the organizations at the estate is an investor in early stage initiatives. They fund initiatives and also contribute in knowledge, experience and network.

Sustainability

The campus aims to make a valuable contribution to the climate objectives. We aim to be circular wherever possible. The Pavilions are WELL Building Certified (Platinum). At WELL Building, the well-being of people is paramount. Where possible, we use The WELL philosophy as a starting point for (policy) choices on our campus. Whereby climate and the environment take precedence over a financial result.

*Contributing to a healthy society.
We house and facilitate companies and
organizations that, like us, are working
towards a natural and healthier society.*

Community Services & Facilities

Landgoed Zonneoord is a country estate in Ede where health, innovation and nature come together. This unique combination makes us an inspiring place to work and meet — whether for focused meetings, impactful conferences or daily business.

Meeting & conference rooms

Our estate offers a wide range of professional meeting and conference rooms, suitable for everything from small team sessions to larger gatherings of up to 100 people. Each space is designed to support productive meetings, with natural surroundings that encourage clarity and creativity.

Additional facilities

To complement your meeting or event, we also provide a variety of indoor and outdoor sports facilities.

Parking

180 free parking spaces.

Park management

- > Charging points for EV
- > 24/7 security
- > Central reception
- > Waste management
- > Technical services
- > Landscape maintenance
- > Shared mountain bikes

Site- and building related services

- > Campus catering
- > High quality green maintenance

Governance

The campus is governed by a board of directors.

Company buildings

- > Groot Zonneoord
- > Nieuw Zonneoord
- > Klein Zonneoord
- > Paviljoen A, B, C, D
- > Tijdelijk Zonneoord



Contact

Knowledge and Innovation Campus Zonneoord
Mirjam Kramer

Zonneoordlaan 17
6718 TK Ede
T: +31 318 65 77 77
receptie@sunnyhome.nl | zonneoord.nl



Lifeport Region

Lifeport Region

Thanks to good cooperation between entrepreneurs, educational and knowledge institutions and the government, you will find a unique business climate here. Everyone - from start-ups, scale-ups, SME entrepreneurs to large multinationals - can benefit. Every day, entrepreneurs, knowledge and educational institutions, governments and social organisations, from small to large, work together in our region.

Lifeport focuses on Energy, Health and High Tech - the growth markets of the future. So here - through campuses and established companies - you will find the right knowledge, opportunities and partners together.

Science & Innovation Parks and Campuses in Lifeport Region

Health

- Campus Nijmegen (3)
 - Novitech Campus, Nijmegen
 - Lifeport Kenniscampus, Nijmegen

Tech

- Campus Nijmegen (3)
 - Novitech Campus, Nijmegen
 - Lifeport Kenniscampus, Nijmegen

Energy

- Cleantech Park Arnhem / Connectr, Arnhem (9)
- Electricity Campus, Arnhem (10)

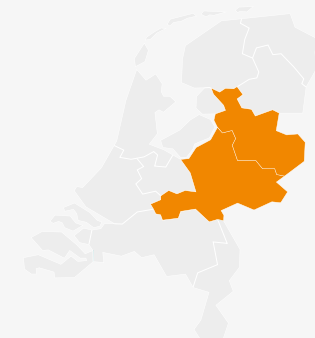

Campus Nijmegen

Radboud Campus (@ Dick van Aalst)

Profile

Campus Nijmegen is a vibrant and forward-thinking center for Health & High Tech innovation, composed of two distinct campuses: Heijendaal and Noviotech Campus. Heijendaal serves as the research hub, home to Radboud University, Radboud University Medical Center (Radboudumc), and the HAN University of Applied Sciences. Noviotech Campus, on the other hand, is a dynamic environment for leading companies, including multinationals in the semiconductor industry, that specialize in advanced technologies, sustainability, and sustainable production processes. Together, Heijendaal and Noviotech Campus form the ideal setting for researchers, entrepreneurs, and businesses to collaborate and create the next generation of Health & High Tech innovations. From cutting-edge chip technologies to breakthroughs in health and sustainability, it all happens at Nijmegen.

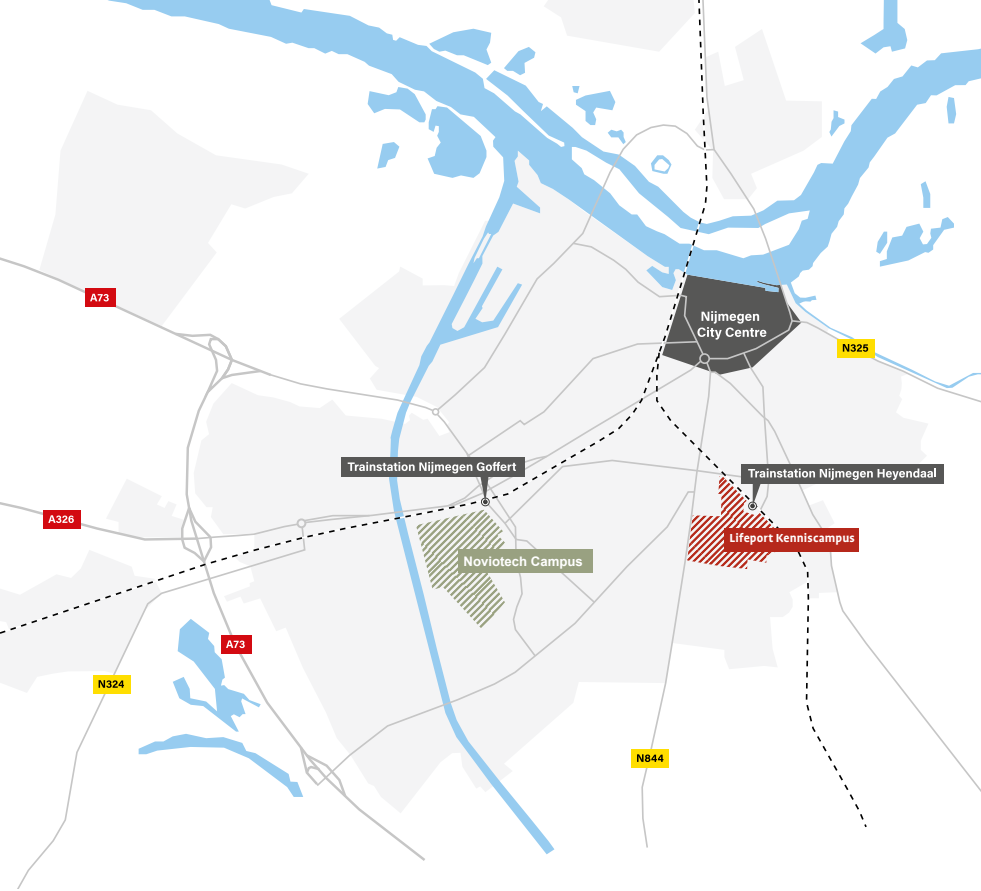

Campus Nijmegen:

Novitech Campus



Lifeport Kenniscampus



Area
1,370,000 m²

Building capacity
270,000 m²

Development Space
100,000 m²

Companies
290

Jobs
25,000

Students
60,000

Campus Nijmegen

Infrastructure

Railway stations

- > Nijmegen Heyendaal
On campus
- > Nijmegen Goffert
On campus

Airports

- > Weeze
52 km - 45 min by car
- > Eindhoven Airport
68 km - 1 hr by car
- > Düsseldorf Airport
120 km - 1 hr 15 min by car
- > Schiphol Amsterdam
120 km - 1 hr 30 min by car and train

Motorway

- > A73
7 km - 10 min by car
- > A15
11.2 km - 14 min by car
- > A50
12.7 km - 16 min by car

Digital infrastructure

- > Fiber and Wi-Fi
- > Campus fully broadband and Wi-Fi serviced

Nijmegen City Center

- > 15 min by bus - 15 min by train -
10 min by car - 10 min by bicycle

Nijmegen - Noviotech Campus

Noviotech Campus: Leading High Tech & Health, Energy & Security Innovation

Noviotech Campus is at the forefront of High Tech & Health, Energy & Security Innovation, providing a unique ecosystem where transformative ideas evolve into impactful solutions.

Located in Nijmegen, it serves as a central hub for businesses, researchers, and entrepreneurs to connect, collaborate, and excel. As the heart of Chip Tech Gelderland, Noviotech Campus plays a key role in advancing chip integration, advanced packaging, and RF (Radio Frequency). Our dynamic community drives innovation in the divers mentioned fields making it the ultimate destination for companies seeking to innovate and grow.

Key Companies

- > Ampleon
- > Chip Integration Technology Center (CITC)
- > Enzyre
- > ITEC
- > Nexperia
- > NXP
- > TropiQ
- > Vaxxinova

Long-term Vision

Noviotech Campus, being one of the named top campuses in The Netherlands, is dedicated to becoming a global hotspot for Health, Energy & Security, with a strong emphasis on advancing semiconductor technologies. Our long-term goals include:

- > Strengthening the Semiconductor Ecosystem: As a core member of Chip Tech Gelderland, we aim to

solidify our leadership in chip technology development, from integration and advanced packaging to RF and sustainable manufacturing.

- > Developing Accessible and Cutting-edge Facilities: We offer stable, user-friendly infrastructure that supports high-quality research, ensuring impactful science and international recognition.
- > Fostering Co-Creation and Knowledge Exchange: By providing an inspiring environment and world-class facilities, we create an ideal space for researchers, entrepreneurs, investors and students to collaborate, innovate, and accelerate progress.
- > Supporting Growth Across All Business Stages: We

provide tailored solutions and support for companies at every stage of growth, ensuring a seamless scale-up experience.

- > Driving Green Innovation: As an ambassador site for Work landscapes of the Future we champion sustainability through circular practices and environmentally friendly initiatives that align with global climate objectives.
- > Developing Talent: Noviotech Campus fosters the personal and professional growth of students, researchers, and entrepreneurs, creating a continuous pipeline of skilled talent for the future. Through collaborations with educational institutions, we attract talent and offer valuable staff exchange opportunities.

Noviotech Campus



Top Campus

Novitech Campus is one of the named top thirteen mature campuses in the Netherlands, meaning it has developed into a leading innovation ecosystem. As such, it is part of the National Campus Consultation. Leading campuses play a central role in finding practical, applicable solutions to major societal challenges. The success of Novitech Campus lies in the interaction between knowledge institutions and established companies, enabling the rapid transformation of knowledge into new business ventures, often through interdisciplinary collaboration.

R&D Focus

At Novitech Campus, innovation thrives at the intersection of technology and Health, Energy & Security. Our R&D focus includes:

- > Semiconductor technologies, with an emphasis on chip integration and packaging;
- > Radio frequency advancements;
- > Digital health, energy & security technologies.

Tailor-made R&D Facilities

In partnership with our partners, Novitech Campus offers custom-designed laboratories and cleanroom spaces for cutting-edge R&D. Whether your focus is chemical, medical, or microbiological research, our facilities meet the highest safety and quality standards. As part of our community, you'll collaborate with ambitious High Tech companies to drive forward your research and business objectives.

Start-up Facilities and Programs

Novitech Campus supports entrepreneurial success through:

- > Briskr: Acceleration programs like Briskr Validate! and the Business Angels Network.
- > Regional Support: Partnerships with StartUp Nijmegen, Orion, and Rijk van Nijmegen (RvN@), providing a strong foundation for start-ups and SMEs to thrive.



Lifeport Semicon Industries

As the central hub for Lifeport Semicon Industries, Novitech Campus plays a crucial role in fostering a robust regional ecosystem for semiconductor innovation. This initiative unites companies, research institutes and both local and central government to advance chip technologies, focusing on areas like chip integration, advanced packaging, RF and sustainable production. With a solid base with companies like NXP, Nexperia, Ampleon, Neways, CITC and ITEC and through collaboration and access to high end facilities, Lifeport Semicon Industries positions the region as a global leader in semiconductor technology.

Community

At Novitech Campus, we believe in the power of connection. Our thriving community is supported by:

- > Variety of Events: Regular meetings designed to foster knowledge sharing, inspire innovation, and create opportunities for professionals to meet and collaborate.
- > New Facilities: Including a state-of-the-art building with dedicated spaces for hosting congresses, networking, collaboration, and relaxation, enhancing the overall campus experience.
- > Exclusive Benefits: Access to shared amenities, professional development opportunities, and a vibrant network of like-minded innovators.

A Green and Sustainable Vision

Novitech Campus is proud to be an official ambassador site for The Work landscape of the future selected by the Dutch government. With initiatives focused on climate adaptation, health, and green development, we are creating a healthy, inclusive, and sustainable campus.

As an ambassador site, we inspire other business parks to implement sustainable practices. Novitech Campus contributes to attracting talent by offering a green, inspiring environment where businesses and innovators can collaborate and thrive.

Join Us

From the next generation of chip technologies to transformative health, energy & security innovations, it's all happening at Novitech Campus. Join a community that is shaping the future!

Nijmegen - Lifeport Kenniscampus

Lifeport Kenniscampus Nijmegen

Lifeport Kenniscampus Nijmegen serves as the research hub, home to Radboud University, Radboud University Medical Center (Radboudumc), ROC Nijmegen and the HAN University of Applied Sciences. Here, groundbreaking innovations in life sciences, neurology, and data science are developed. The campus also hosts companies and spin-offs from Radboud University, focused on high-tech advancements.

Unique Companies

Science Park including 60 science-based start-ups, SMEs, and other companies working closely with the university and Radboudumc.

- > Health / medtech / AI / data science companies
- > Deeptech / hightech / quantum / space companies
- > Edtech companies
- > Social impact / sustainability companies

Facilities and Programs

Various facilities and programs for start- & scale-ups are available:

- > Flexdesks
- > Flex-Offices
- > Flexible labspaces
- > Shared labs and research facilities
- > Active ecosystem management
- > Active Sciencepark Community
- > **Mercator Launch** stimulates entrepreneurship and innovation in the early phase. The Center of Entrepreneurship of HAN university also stimulates entrepreneurship. The start-up facilities and program

help entrepreneurs showcase and further develop their business ideas, and they support the start-ups that emerge from these ideas. Based on their in-house expertise, the staff of Mercator Launch helps entrepreneurs to develop business cases. Moreover, with their extensive academic and business networks that transcend the region, Mercator Launch can put you in contact with national and international businesses, partners, and potential clients. Hundreds of innovative scientists and students have been successfully supported by Mercator Launch.

- > **Briskr** supports and stimulates entrepreneurship in Health & High Tech. Through various acceleration programs and other activities – like Briskr Validate!, NextOEM and the Business Angels Network Nijmegen – they stimulate and support entrepreneurs in taking the next step with their innovation.
- > Through **Radboud Research Facilities** companies, research institutions, researchers, and startups can take advantage of the facilities and knowledge of Radboud

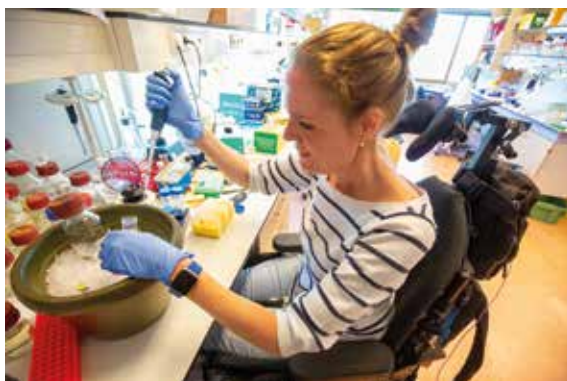

RIMLS Molecular Biology (@Dick van Aalst)



High Field Magnet Laboratory and Free Electron Laser for Infrared Experiments (@ Dick van Aalst)

University, Radboudumc, and the Donders Institute.

Radboud Research Facilities (RRF) offers a wide range of services and expertise within eight research areas: medical research, decision making, space, language and speech, neurology and motion, data science, plant and animal models, and molecules and materials.

Furthermore, RRF helps to enhance the existing facilities and always aims to purchase the latest equipment aiming to create an optimal research environment.

- > **Radboud Sports Center** providing over 80 different sport options for students, alumni, employees, and citizens of Nijmegen and surroundings;
- > **Facilities & Services** including several restaurants and cafes/pubs on campus;

World-class Research Institutes

- > **Radboud University**: hosts 14 research institutes on campus, many of which are world leading in their field.
- > **Radboud University Medical Center**: research into current scientific health challenges: Radboud Institute for Molecular Life Sciences, Radboud Institute for Health

Sciences, Radboud Center for Language and Speech Technology.

- > Donders Institute for Brain, Cognition and Behaviour.
- > Max Planck Institute for Psycholinguistics: the only institute in the world entirely devoted to psycholinguistics.
- > Radboud Center of Artificial Intelligence: a global forerunner on research into human-centered AI technology.
- > OnePlanet Research Center (consisting of IMEC and Wageningen University and Research): research for a healthy and sustainable society using the latest chip and digital technologies.
- > Sint Maartensclinic: specialized in orthopedics, rheumatology, rehabilitation and pain management in the field of posture and movement.
- > The High Field Magnet Laboratory (HFML), Free-Electron Lasers for Infrared eXperiment (FELIX) institute: part of the national institutes within NWO (Dutch Research Council) and a unique facility in the world.
- > Research & Business developments: Big Chemistry (Robot Lab), Neurovate, RF Knowledge Lab, Digital Health

Challenge Lab, AI/Data Lab-Oost, Nolai lab, DYNAMIC (14 tesla MRI scanner).

Remarkable high-tech achievements

- > The Radboud Radio Lab successfully invented the radio antenna, the Netherlands-China Low-Frequency Explorer (NCLE), which is placed on the Chinese Queqiao satellite behind the moon and successfully provides data (led by Professor Marc Klein Wolt);
- > The Dutch National 14Tesla MRI Initiative in Medical Science (DYNAMIC) will be the strongest MRI-scanner in the world. During 2027 this facility will be constructed on campus. The project is initiated by Radboud University (responsible institution), Amsterdam Medical Centre (AMC), Leiden University Medical Centre (LUMC), Maastricht University, Radboud University Medical Centre, Spinoza Centre for Neuroimaging – KNAW and University Medical Centre Utrecht (UMCU)
- > The Event Horizon Telescope Collaboration team of astronomers revealed the first image ever of the Black Hole at the heart of our own Milky Way led by Professor Heino Falcke.

The perfect ecosystem for entrepreneurs in Health & High Tech to develop their groundbreaking innovations. From the next generation of chip & RF technology to the neurotech development, it's happening on Campus Nijmegen.



Spectroscopy of Solids and Interfaces (@ Dick van Aalst)

Radboud Universiteit



Contact

Radboud University
Mathijs Buddingh'
Projectmanager Science Park | Radboud University
Houtlaan 4
6525 XZ Nijmegen
T: +31 6 27 01 41 87
sciencepark@ru.nl | ru.nl/sciencepark



Contact

Noviotech Campus
Transistorweg 7N
6534 AT Nijmegen
T: +31 24 204 90 60
info@noviotechcampus.com | noviotechcampus.com

HAN UNIVERSITY OF APPLIED SCIENCES

Contact

HAN - ORION
Einte Visser
Center for Entrepreneurship
Kapittelweg 33
6525 EN Nijmegen
T: +31 6 29 02 30 30
einte.visser@han.nl | orion-gelderland.nl

Cleantech Park Arnhem

An aerial photograph of Cleantech Park Arnhem, showing a large industrial complex with several large buildings, some with solar panels on their roofs. The park is surrounded by green fields and a river. In the background, two large wind turbines are visible against a clear blue sky.

Profile

Cleantech Park Arnhem in Arnhem is a unique 90 hectare production campus that houses, facilitates and connects sustainable energy and circular related companies and test facilities. The cleantech campus of the future is being worked on together with the government, education and the business community.

Sustainability is in our veins. It is reflected in the focus of the companies that establish themselves here, the design of the park, and the collaborative partnerships it nurtures among businesses.



Infrastructure

Railway stations

- > Arnhem Centraal
4.2 km - 22 min by bus
- > Westervoort
3.2 km - 20 min by bus

Airports

- > Weeze
65 km - 1 hr by car
- > Eindhoven Airport
87 km - 55 min by car
- > Schiphol
116 km - 1 hr 15 min by car

Motorways

- > A12: 3.5 km - 5 min by car
- > A50: 10.5 km - 10 min by car
- > A15: 14.5 km - 15 min by car

Digital infrastructure

- > Fiber, Wi-Fi and fully broadband

City Center

- > Arnhem
21 min by bus - 3 min by car -
5 min by bicycle
- > Nijmegen
1 hr 19 min by bus - 25 min by car -
1 hr by bicycle
- > Wageningen
1 hr 12 min by bus - 33 min by car -
1 hr 10 min by bicycle



Area

900,000 m²

Building capacity

25,000 m²

Development space

100,000 m²

Companies

140

Jobs

2,500-3,000

Students

**200 per day
on average**

Cleantech Park Arnhem

Long-term Vision

We aim to develop the park into a campus where companies related to the energy transition or circular economy can establish themselves and thrive. We provide ideal conditions for these companies to effectively and seamlessly bring their products to market.

The energy transition requires significant leaps in scale, necessitating the accelerated adoption and scaling of innovations. That's why Connectr Energy-innovation is situated on our campus. Connectr caters to this demand by focusing on electrical grid enhancements, storage solutions, and mobility innovations.

In 2024 we have developed the Connectr Innovation Lab: a physical location featuring shared research and development facilities, hybrid learning environments, testing grounds, and meeting and event spaces.



HAN University of Applied Sciences at Connectr Innovation Lab



Cleantech community on Cleantech Park Arnhem

Open Innovation Strategy

Everything developed within the Connectr ecosystem is open access. Involving education is crucial as educational institutions must play a role in every program initiated within Connectr. To achieve the necessary scale for the energy transition, open access is highly desirable. At the campus we make greater progress by sharing knowledge and experiences.

Parties aligned with Connectr (but not located in the Connectr Innovation Lab) can pursue their own commercial activities privately, following their respective intellectual property guidelines.

Cleantech Park Arnhem is a unique 90 hectare production campus that houses, facilitates and connects sustainable energy and circular related companies and test facilities. The cleantech campus of the future is being worked on together with the government, education and the business community.

R&D Focus

To accelerate the energy transition, we have established a hub at Cleantech Park Arnhem, Connectr, where research, education, startups, and established companies can leverage shared facilities to collectively advance.

Connectr focuses on 3 program areas:

1. *The electrical grid as connector*, ensuring that it can effectively fulfill its crucial role in sustainability by integrating sustainable sources and accommodating new uses, including sector coupling;
2. *Energy storage as a flexible buffer*, involving the development and implementation of efficient electrochemical energy storage systems within a sustainable energy framework;
3. *Smart and green drive technology*, which seeks to provide innovative drive technology solutions based on sustainable fuels, possibly in conjunction with electric drive components, to address the challenges of the energy transition.

Shared facilities

At the campus, together with Connectr, we offer shared facilities:

- > Connectr Shared Office
- > Connectr Energy Demo Field
- > ElaadNL Testlab
- > Powerlab
- > HAN H2Lab

Start-up Facilities and Programs

The region has chosen to centralize all energy startup facilities at Connectr. Housing, shared facilities, guidance, finance and investment programs and port programs will all be situated in and around the Connectr Innovation Lab. Furthermore, other startups, such as those related to the circular economy, are also encouraged to join the campus.

World-class Research Institutes

- > HAN University of Applied Sciences
- > Radboud University
- > Intensive cooperation with the technical universities in the Netherlands; principally with the TU Delft
- > Also, world-class commercial research institutes such as TÜV, and the European test facilities of ElaadNL are located at Cleantech Park Arnhem.

Sustainability

Cleantech Park Arnhem serves as an important sustainability testbed. We are dedicated to enhancing the sustainability of energy use in this location. At the campus research focuses on circular energy solutions and the utilization of local raw materials and fuels. We prioritize minimizing waste through thorough separation for subsequent collection and recycling into new products and raw materials. Additionally, the park has been a key location for charging solutions and hydrogen solutions for many years. Furthermore, both the park and its buildings are designed or redesigned with sustainability in mind. Our ambition is to maintain our status as the most sustainable business park in the Netherlands.

The objective is to rely solely on locally generated sustainable energy by 2050.

- > At the moment we generate renewable electricity locally on campus through a wind turbine (8,500 MWh per year), 24,000 solar panels (6,700 MWh per year) and a small biomass boiler (5,500 MWh). In 2023 about 48,5% of the electricity used on campus is generated in a renewable way.
- > To get to 100% renewable energy in 2050 we will:
 - Provide efficient and large-scale storage of sustainably



King Willem-Alexander visits the hydrogen cluster at Cleantech Park Arnhem

Cleantech Park Arnhem

generated electricity (to resolve fluctuation in supply and demand) using hydrogen, batteries and car batteries;

- Generate and utilize heat and steam in a variety of ways (or exploring opportunities to do so), such as through wastewater treatment, cooling water, waste heat, PVT panels, hydrogen and geothermal energy;
- By adding flexibility to the demand side through the introduction of flexible contracts and a capacity sharing system, we can better align with the flexible production of additional renewable energy sources, facilitating their integration.
- Continuously work on new ideas and innovations in the sustainable energy sector.

Community Services & Facilities

With its diverse array of facilities, Cleantech Park Arnhem actively fosters and supports a dynamic cleantech community. The principles of collaboration and knowledge-sharing are central, as facilitated by the park restaurant, in-house Technical Services, and free boot camps. Furthermore, the park regularly hosts events, meetings, and product launches, all contributing to the creation of a unique space steeped in history.

Leisure

- > Park restaurant and catering
- > Free boot camp twice a week
- > 150+ events each year
- > Walking routes

Parking

- > 1,310 free parking spaces for cars, including 136 charging points for EV
- > 432 parking spaces for bicycles



Connectr Shared Office

Park management

> Site related services:

- > H2 backbone
- > EV charging plaza
- > Hydrogen fueling station
- > Test facilities for EV
- > Test facilities for hydrogen
- > Various utilities, including steam at various pressure levels up to 100 tons p/h, natural gas, network management, various grades of water, compressed air and wastewater treatment
- > 24/7 security
- > Central reception

> Waste management

- > Technical services
- > Weigh bridge
- > Landscape maintenance
- > Meeting rooms (Act Eventstudios)
- > Event location (Act Eventstudios)
- > Recruitment program (Werken op Cleantech Park Arnhem)
- > Galleries and expositions

> Building related services:

When renting a building or space, we provide utilities (through Veolia), technical services and park management. If your business is involved in the

energy transition, you have the opportunity to become a part of the Connectr ecosystem. You can rent a business unit or starting from just as little as one desk, gaining access to all of its facilities and networking opportunities. The requirement is that your business is actively involved in one of the key technologies and has a strong commitment to advancing the energy transition.

- > Shared office
- > Meeting rooms
- > Demo rooms
- > Demo field
- > Offices
- > Lab space

Design

A design cluster is based on our park. Designers work closely with makers, researchers, and technological innovators. Through collaboration and cross-pollination, innovative designs and surprising perspectives emerge. Driven by a belief in innovation, creativity, and making, we facilitate and encourage cross-overs between different fields, such as design and technology.



Charging plaza at Cleantech Park Arnhem

Governance

Campus ownership

Cleantech Park Arnhem is a private company and is being developed by Schipper Bosch holding.

Commitment & support

Cleantech Park Arnhem is supported by Gemeente Arnhem, Provincie Gelderland, Oost NL and The Economic Board Regio Arnhem Nijmegen.

Buildings

The entire campus comprises 140 different companies. Many of these companies work on clean technologies. There is still space for new businesses to set up within the existing buildings and there is still space for development in areas of the campus. These plots are also designated for high environmental impact industries.

Students

Student housing is a future plan. Because there is sufficient student housing in the area, this won't be included in the plans for the coming years.

Short stay

In the near future, short stay accommodation will be developed.



Cleantech Park Arnhem

Contact

Cleantech Park Arnhem

Jet van Zwieten

CEO

Westervoortsedijk 73

6827 AV Arnhem

T: +31 26 384 46 46

hallo@cleantechparkarnhem.nl

cleantechparkarnhem.nl

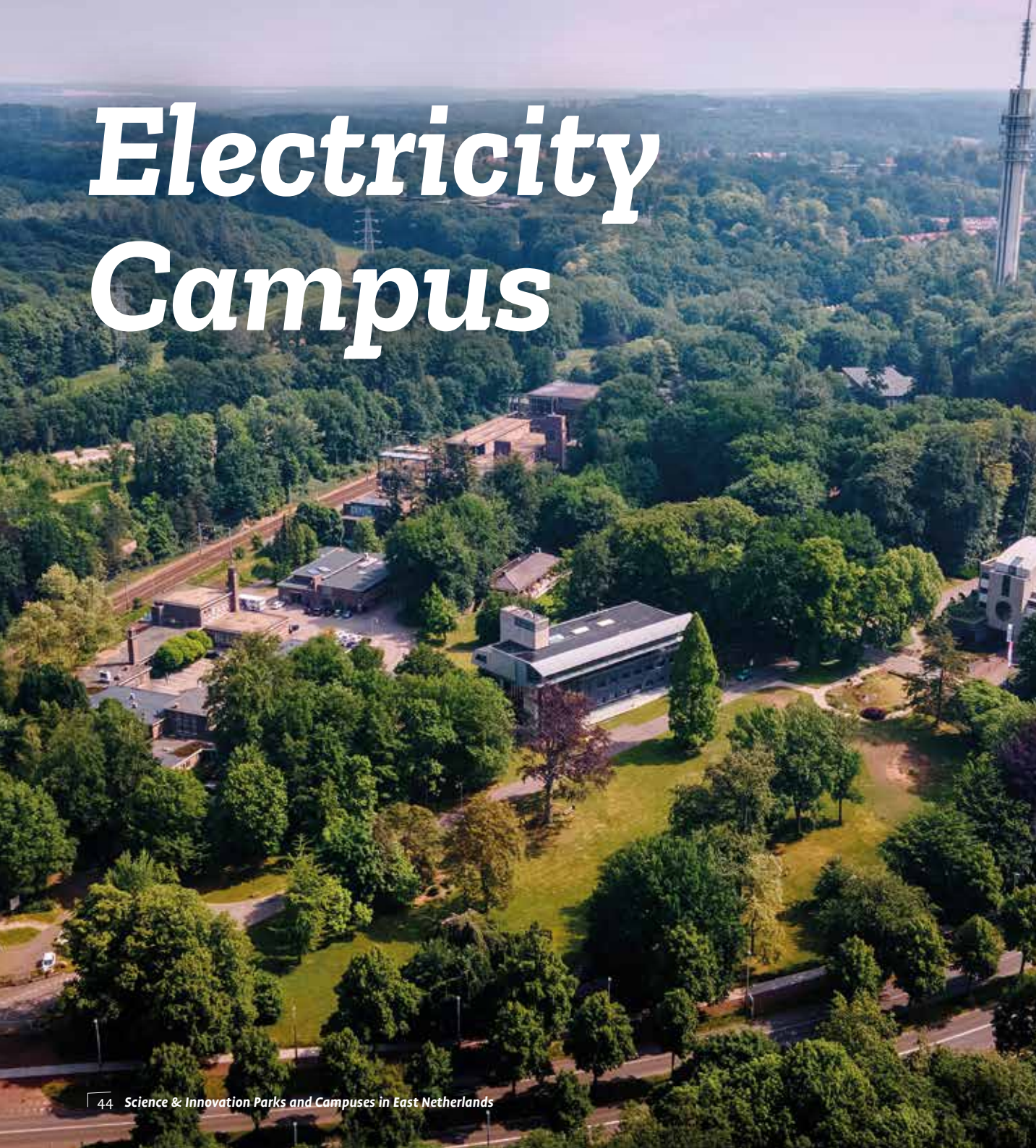

Electricity Campus

Profile

At Electricity Campus, often better known as the former KEMA site, the energy transition has been a central theme for almost 100 years. It is a beautifully landscaped park with several monumental buildings which house prominent companies and institutions such as the Dutch electricity transmission manager TenneT, the high-quality test labs of Kema, Hyosung Heavy Industries (focuses on renewable energy with industrial energy storage systems and transformers), the international consultancy firm DNV and NRG Pallas. The captivating park is a contemporary and inspiring work location for (knowledge) institutions and knowledge-intensive companies that work on the current energy transition. Many campus facilities can be found in the park and its immediate vicinity, including meeting & conference facilities, a brasserie, a start-up center, flex spaces, sports facilities, and short-stay housing.

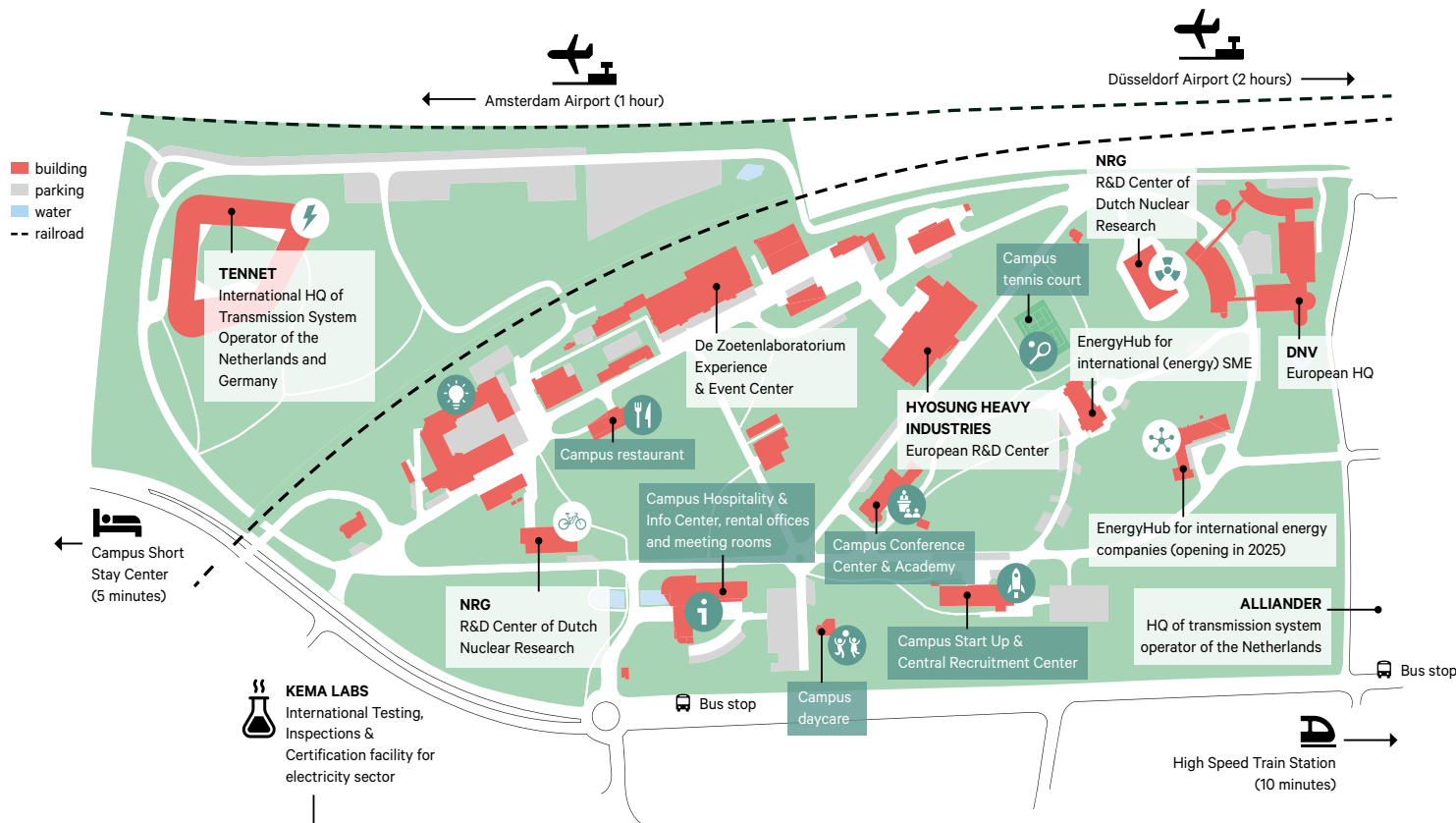

Area
200,000 m²

Building capacity
33,000 m²

Development space
20,000 m²

Companies
143

Jobs
1,250

Infrastructure

Railway stations

- > Arnhem Centraal (ICE)
2 km - 10 min by bus
- > Oosterbeek
2.4 km - 15 min by car

Airports

- > Weeze
66 km - 1 hr by car
- > Eindhoven Airport
83 km - 1 hr by car
- > Schiphol
106 km - 1 hr 15 min by car

Motorways

- > A12
8.3 km - 10 min by car
- > A50
8.5 km - 10 min by car
- > A15
16.3 km - 15 min by car

Digital infrastructure

- > Fiber, Wi-Fi and fully broadband

City Center

- > Arnhem
10 min by bus - 5 min by car -
10 min by bicycle
- > Nijmegen
38 min by bus - 30 min by car -
1 hr 10 min by bicycle
- > Wageningen
31 min by bus - 20 min by car -
50 min by bicycle

Electricity Campus

Long-term Vision

The Electricity Campus is a national monument park near Arnhem Central Station. The emphasis is on accessibility via sustainable (shared) transportation. Constant investments are made to further strengthen the high-quality green environment and its resilience. The campus will be made more sustainable in the coming years with its own energy generation, sustainable installations, and intelligent exchange and balancing systems. The historic buildings will be made more sustainable in phases.



The campus will be made more sustainable in the coming years with its own energy generation, sustainable installations, and intelligent exchange and balancing systems.

Community Services & Facilities

The central theme is excellence in reliability, service, safety, and appearance. We have the best of both worlds at the Electricity Campus: interaction between excellent international parties and inspiring new ideas. And all this in an amazing, green environment.

Electricity Campus has a significant legacy in R&D, thanks to its KEMA past. The park will be further developed in the coming years, further strengthening the R&D landscape. The R&D focuses on digitizing the components on high- and medium-voltage grids, substations, and the use of open data and AI for, among other things, predictive maintenance, energy exchange, and grid optimization. Investments are made to develop shared facilities. Three buildings in the heart of the campus have been selected for this purpose.

Electricity Campus is part of the Arnhem Electricity Hotspot ecosystem. This includes knowledge institutions Van Hall Larenstein and the Han University of Applied Sciences, as well as Connectr and Cleantech Park Arnhem. These parties offer several facilities and programs for start-ups. The start-up facilities on Electricity Campus are housed in the prominent heart of the campus.

Connectr accelerates the application and scaling up of innovations in the energy transition, with the help of an Innovation Program, Innovation Lab, Shared Facilities, and the Core Organization. Innovations are tested, demonstrated, and put into practice directly from Connectr, in order to grow from there.

Leisure (sports, congress and cultural events)

Fitness facilities, tennis courts, conference & meeting centers, various biking, hiking, and mountain bike trails.

Parking

Around 450 parking spaces spread over the campus, including loading infrastructure on request.

Park management

- > Site-related services
 - National monument park, hospitality center, child day care center, restaurant/lunchroom,
- > Building-related services
 - High-speed internet, Wi-Fi, meeting rooms, pantry facilities

Governance

The public-private partnership between Oost NL and City Developer-S owns Electricity Campus. The joint focus is to further strengthen a high-quality and knowledge-intensive environment with a key position in the current energy transition. Stimulating and driving the regional sustainable economy is central to this, which is done by strengthening cooperation in a high-quality, unique, green environment.

Commitment

Various companies, international headquarters, and institutions have relocated to in recent years or have always been located here. This community is constantly changing and rapidly growing. Redeveloping 50 to 100-year-old energy labs leads to constantly emerging new inspiring environments to work, discover and innovate in.

Buildings

Education and Research	Ca 1-5
Company buildings	Ca 25
Housing (students)	15 studios



ELECTRICITY CAMPUS

Contact

Electricity Campus at Arnheims Buiten
Thijs van Dieren | Dennis van Huisum

Utrechtsweg 310
6812 AR Arnhem
T: +31 26 352 30 00
dennisvanhuisum@electricitycampus.com.
electricitycampus.com

Twente Region

Twente Region

In Twente, people work on a better world and the innovations of tomorrow by using high-end technologies – from advanced chips to life-saving robotics. Twente offers the space for ideas to grow. It's where innovative companies and big thinkers come together to work on groundbreaking innovations and inventions that make an impact both nationally and internationally, all while contributing to the well-being of people in Twente – and far beyond.

Twente also provides the infrastructure and support needed to turn bold ideas into reality. With strong knowledge institutions and specialised research centres, the region is at the forefront of knowledge development. And thanks to a powerful ecosystem of knowledge, tech and entrepreneurship, Twente continues to lead the way in technological progress and innovation – always with a clear focus on social impact.

Science & Innovation Parks and Campuses in Twente Region

Tech

Kennispark Twente, Enschede (1)
Technology Base, Enschede (2)
High Tech Systems Park, Hengelo (8)
XL Businesspark, Almelo (12)
Connect-U, Enschede (16)

Health

Connect-U, Enschede (16)

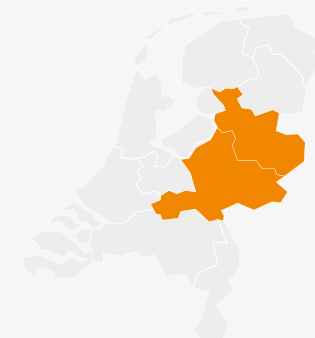

Connect-U

A photograph of the Connect-U campus in Enschede. In the foreground, there is a statue of a person in a long dress, standing on a pedestal. Behind the statue is a modern building with large windows and a dark facade. The building has a large 'U' logo on its side. The sky is blue with some clouds.

Profile

Connect-U is located in the heart of city campus in Enschede, a vibrant campus where education, research, and entrepreneurship converge. The campus is home to over 18,000 students from Saxion University of Applied Sciences and the Regional Community College of Twente, creating a strong foundation for collaboration and innovation.

Housed in a renovated former hospital on the campus, Connect-U offers a dynamic environment with 400+ rooms and apartments for students and young professionals and workspace for 30 companies, from start-ups to scale-ups. Here, entrepreneurs, researchers, lecturers and students work, live, learn, and meet together.

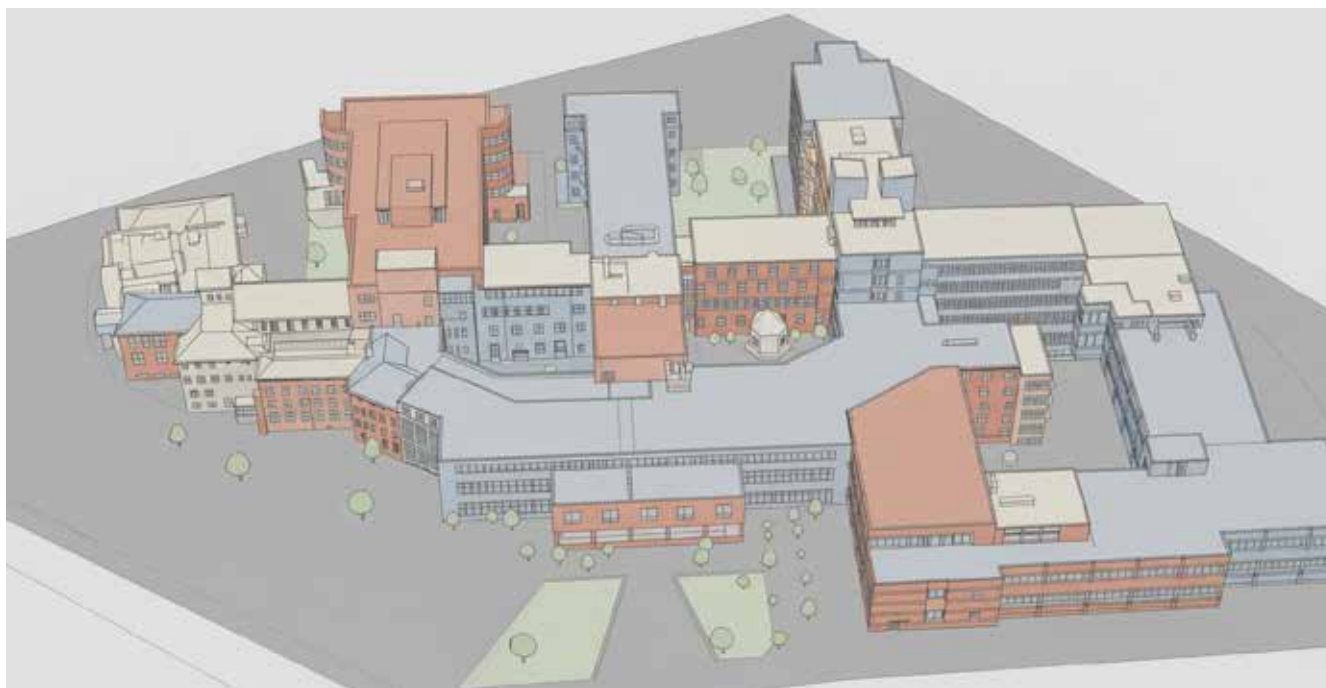

Area
65,000 m²

Building capacity
55,000 m²

Development space
15,000 m²

Companies
30

Jobs
250

Students
18,000

Infrastructure

Railway stations

- > Enschede Central
0.6 km

Airports

- > Münster -Osnabrück
87 km - 1 hr 30 min by car
- > Schiphol Amsterdam
170 km - 1 hr 35 by car | 2 h 15 min by train
- > Eindhoven Airport
182 km - 1 hr 45 min by car

Motorways

- > A35
2.5 km - 5 min by car
- > A1
11.5 km - 19 min by car

Digital infrastructure

- > Fiber, Wi-Fi and fully broadband

City Center

- > Enschede
0.2 km - 1 min by bicycle

Connect-U

Long-term Vision

Connect-U focuses on strengthening a sustainable ecosystem in which education, research, and business reinforce each other. The place supports the aim of retaining talent, enabling companies to grow, and stimulating the regional economy. Connect-U forms a vibrant community of knowledge institutions, companies, students, and citizens, who work together on solutions to social challenges while creating new market opportunities for the organizations involved.

Open Innovation Strategy

The Netherlands of tomorrow requires smart solutions to social, ecological, and economic issues. In Twente, this challenge is being translated into action: here, knowledge institutions, companies, and governments are working together on innovation with impact. Special focus is on applying technology in healthcare and sports that can contribute to the personal wellbeing. Connect-U is creating a unique environment where learning, working, and innovating reinforce each other and where applied research is translated into new products, services, and business models. Co-creation and knowledge sharing are creating a sustainable ecosystem that stimulates talent development and strengthens innovative power in the Twente region. This approach contributes to economic growth, talent retention, and the development of practical solutions for the social and technological issues of today and tomorrow.

World-class Research Institutes

- > Thermoplastic Composites Application Center
Research center focused on the application of thermoplastic composites and the development of production processes for (regional) SMEs.



- > Smart Mechatronics, Robotics and Drones
Smart Mechatronics and Robotics develops robotics, mechatronics, and AI technologies through applied and mission-driven research in collaboration with educational institutions, companies, and social partners to provide practical solutions to urgent social and technological challenges.
- > Quantum Talent & Learning Center / Applied Quantum Photonics Lab
The Quantum Talent & Learning Center focuses on applied research and talent development in quantum technology, in collaboration with companies, educational institutions, and knowledge partners in Twente.

Connect-U is a growing ecosystem where business, education, and research come together in a vibrant community that actively shapes collaboration and innovation.

R&D Focus

The R&D focus is on applied technology with strong regional impact through collaboration between education, research and business:

- > Smart Materials
Thermoplastic composites, lightweight constructions, sustainable and functional materials, circular use of textiles.
- > Robotics & Artificial Intelligence
Applied robotics, unmanned robotics systems, smart industrial systems, sensing & perception.
- > Data & Digital Innovation
Data analysis, machine learning & AI, predictive modelling, data-driven decision making, digital transformation & innovation.
- > Extended Reality (XR)
Virtual and augmented reality, simulation, training and serious gaming.
- > Quantum Technology
Applied research in integrated photonic circuits talent development in quantum technology.

Shared R&D facilities

Connect-U is home to a variety of research and innovation centers where students, researchers, and companies collaborate on applied technologies. The state of art facilities supports R&D in robotics, mechatronics, smart materials, 3D concrete printing, extended reality, and quantum technology, fostering partnerships between industry and educational institutions.

- > Mechatronic lab
Development and testing of mechatronic systems, automation and robotics.
- > Outdoor and indoor Dronedome
Open-air testing environment for drones and

autonomous flight systems and a controlled indoor testing space (6x6) for safe drone experiments.

- > Smart Industrial Systems lab
Development of intelligent production and automation solutions.
- > Thermoplastic Composites Application Center (TPAC)
Research center focused on the application of thermoplastic composites and the development of production processes for (regional) SMEs.
- > 3D concrete printing lab
Possibility to create large objects by printing structures with concrete.
- > Extended Reality Lab
An innovative environment with advanced equipment for prototyping and experimentation in VR, AR, motion capture, and computer vision, supporting applications in gaming, simulation, rehabilitation and training.



- > Applied Quantum Photonics Lab / Quantum talent & learning Center
Applied research in integrated photonic circuits.
- > Fablab
Creative workspace with a wide range of digital prototyping machines and tools for prototyping, digital fabrication, and experimentation with new materials and technologies, including 3D printers, 3D scanners, CNC milling machines, laser cutters, and PCB milling machines.
- > Pioneering
Community-driven platform and cooperation of companies to stimulate applied innovation in sustainable and circular construction.
- > Gamelab Oost
A creative hub for serious gaming, where students, professionals, and companies collaborate to develop, test, and implement innovative digital solutions for societal challenges.
- > TValley
An innovation cluster that brings together industry, education and research to co-create advanced mechatronics, robotics and AI solutions and train the next generation of engineering talent in the East Netherlands.

Start-up facilities

The Saxion Centre for Entrepreneurship at Connect-U supports students and start-ups in developing their businesses through education programs, coaching, and access to an incubator. The Centre also offers traineeships, allowing recent graduates to gain hands-on experience across various organizations. Yearly, around 250 talents are guided and supported. It strengthens collaboration between education and industry while giving

Connect-U

companies the opportunity to discover and mentor young professionals.

Sustainability

Housed in the renovated former city hospital, the redevelopment itself represents a strong example of sustainable building and adaptive reuse. Preserving cultural heritage while reducing environmental impact. Connect-U is connected to the city's district heating network, and plans are in place for the installation of solar panels to further minimize energy use.

Community Services & Facilities

- > Office and workspaces for companies and start-ups
- > Dedicated desks
- > Student housing for national and international students
- > Studios for young professionals
- > A vibrant event program accessible to companies
- > Hospitality with event and meeting spaces for up to 500 people
- > Access to educational institutes Saxion University of Applied Science and Regional Community College of Twente
- > A lively community focused on collaboration and innovation with 10+ community events yearly
- > Electric vehicle charging stations
- > 24/7 access
- > Central reception
- > Rooftop terrace
- > Restaurant

Leisure

- > Meeting and event facilities for workshops, seminars, congress and corporate gatherings



- > Flexible room layouts with audiovisual equipment, flipcharts, and WIFI
- > Catering available facilitated by A-square
- > Centrally located in Enschede, close to cultural and sports facilities and just a few minutes' walk from the city park and its World War II memorial

Parking

140 (paid) parking spaces indoors and on two sites on the spot outside.

Site-related services

- > 24/7 access
- > Electric vehicle charging stations

- > Package pick-up
- > Landscape service
- > Technical services



Building-related services

- > Flexible office spaces and dedicated desks
- > Meeting facilities
- > Reception
- > Technical support
- > Cleaning
- > Printing and copying facilities
- > High-speed internet
- > WI-FI
- > Catering facilities by A-square

Governance

Connect-U is 100% owned by Xior, a publicly listed company on Euronext Brussels (100% Xior Student Housing NV). Connect-U has a steering committee chaired by the director of the Saxion Centre for Entrepreneurship. In addition, there is a foundation responsible for community activities.

Commitment

Saxion University of Applied Science, Regional Community College of Twente, Twente Board Development, The municipality of Enschede, Xior and NovelT.

Buildings

Education and Research 16,000 m²

Company buildings

- > Living 11,000 m²
- > Building 22,000 m²

Housing

- > For students 310 units
- > Studios for young professionals 92 units

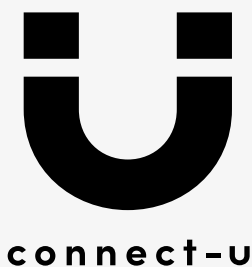

Contact

Connect-U City campus

Location manager: Robin van der Meij

Business communities: Annemarie Penders

Ariënsplein 1

7511 JX Enschede

T: +31 6 89 97 23 86

info@connect-u.nl | connect-u.nl

High Tech Systems Park

An aerial photograph of the High Tech Systems Park (HTSP) in Enschede, Netherlands. The image shows two large, modern, multi-story office buildings with flat roofs and extensive glass facades. The buildings are surrounded by lush green trees and landscaped grounds. In the background, other industrial and commercial buildings are visible, along with a parking lot filled with cars. The sky is clear and bright, suggesting a sunny day.

Profile

The High Tech Systems Park (HTSP) is located right next to one of the largest business parks in the north-east of the Netherlands (Twente Canal business park). Located multimodally along the Twentekanaal and the A35 motorway, close to the urban development Hart van Zuid and Hengelo Central Station, and in the urban development area Spoorzone Hengelo-Enschede.

The concentration of high-tech companies and high-tech employment is unique for eastern Netherlands and a driver for the ambitions of the Twente Board to grow into a green technology top region.

The companies at the HTSP are all part of Twente's high-tech ecosystem of companies, educational institutions and governments.



Infrastructure

Railway stations

- > Hengelo
5 km - 10 min by bus
- > Enschede
12 km - 12 min by car

Airport

- > Münster-Osnabrück
89 km - 1 hr 10 min by car
- > Düsseldorf Airport
135 km - 1 hr 30 min by car
- > Schiphol
163 km - 1 hr 45 min by car

Motorway

- > A35
1.5 km - 3 min by car

Digital infrastructure

- > Fiber and Wi-Fi. Park fully broadband and Wi-Fi serviced.

City Center

- > Hengelo: 10 min by bus - 10 min by car - 12 min by bicycle
- > Enschede: 6 min by train - 40 min by bus - 18 min by car - 40 min by bicycle
- > University of Twente: 7.6 km



Area

216,000 m²

Development Space

20,000 m²

Companies

46

Jobs

3,400

High Tech Systems Park

Long-term Vision

Accelerate growth through collaboration between high tech systems scale-up and grown-up companies by offering effective business support at a high quality, inspiring campus. The HTSP is a showcase for other high-tech parks and a frontrunner for the industry in Twente. The HTSP creates a sustainable competitive advantage by knowledge sharing between entrepreneurs and sharing of R&D equipment. Most companies at the HTSP have a profile in the area of Critical Systems, and are part of the Defense and security, Public Infrastructure or Environment industry.

The HTSP has a sustainability policy that entails the creation of a green, healthy and inclusive campus with a positive impact in terms of climate and creating a circular economy. In addition, this policy has led to the mobility hub, good public transport access and charging points.

Open Innovation Strategy

Turn ideas and cooperation into products and competitive advantage:

- > An inspiring and hospitable environment in which (local) start-ups can turn innovative ideas into products, reducing the time-to-market and setting up viable businesses;
- > An attractive meeting place to share latest technological developments and to stimulate co-creation through excellent facilities and academic and business networks;
- > The best housing and living environment for companies and its employees in all stages of growth;
- > Stimulate entrepreneurship and innovation; shortening the time to market;

- > A flourishing entrepreneur community where new ideas and initiatives originate;
- > Facilitates entrepreneurs with flexible housing opportunities;
- > Comprehensive environmental test facilities / “First time right” design validation.

We act as a bridge between companies, disciplines and markets to create a perfect place to innovate and establish new business opportunities. Multinationals as well as small and medium-sized high-tech companies, research institutes, service companies, scale-ups and startups are working together, since sharing knowledge is as important as developing knowledge.

World-class Research Institutes

High Tech Systems park is connected to the four other top business parks in Twente (Technology Base, XL Businesspark, Stadscampus Connect-U and Kennispark Twente). The HTSP companies work with the following knowledge institutes, among others:

- > University of Twente;
- > Saxion University of Applied Sciences;
- > Delft University of Technology;
- > Eindhoven University of Technology.



R&D Focus

The R&D focus areas within the HTSP are within the following themes:

- > Defense and Security;
- > Public Infrastructure;
- > Environmental solutions;
- > Advanced manufacturing.

Shared R&D Facilities

Several shared R&D facilities are available within the companies at the HTSP, giving companies the opportunity to develop and test products or systems:

- > Environmental Competence Center;
- > Digital smart factory;
- > Ambient intelligence;
 - o Sensor technology, artificial Intelligence and augmented reality.

Start-up Facilities

At Gebouw N, entrepreneurs and companies meet easily and with low barriers to strengthen their business operations. Over 30 innovative companies are renting office space in Gebouw N.



High Tech Systems Park

Sustainability

The HTSP has a unique form of heat supply for the companies, the so-called Bronnet. Bronnet is a sustainable energy network using smart technologies to manage energy distribution efficiently. Combining heat pump technology, cooling water from the Twentekanaal, residual heat from the Hengelo district heating and complex IT-infrastructure to cool and heat offices and factories with minimum energy consumption. This makes the companies' gas consumption (much) lower than that of companies that are only gas-fired.

Through Bronnet, the companies' CO2 emissions are reduced by at least 50 percent and energy savings exceed 20 percent. In addition to direct savings, the Bronnet field lab also offers opportunities for innovation, such as with big data, energy storage or other developments on a live network.

Part of the Bronnet is the opportunity for companies and start-ups to develop and test new applications directly on a live network.

Companies at the HTSP gain an operational sustainability advantage as well as a business advantage from the Bronnet.

The HTSP is a showcase for other high-tech parks and a frontrunner for the industry in Twente. The HTSP creates a sustainable competitive advantage by knowledge sharing between entrepreneurs and sharing of R&D equipment.



Community Services & Facilities

The HTSP offers a broad range of services and facilities, such as:

Park management

- > Charging sockets for EV
- > Bus stop; High Tech Systems Park
- > 24/7 security
- > Waste management
- > Technical services
- > Landscape services

Shared facilities

- > Community Management
- > Meeting rooms
- > Shared workplaces
- > Demo rooms
- > Restaurants and catering
- > Social facilities
- > Sport/leisure facilities
- > Walking routes
- > Events, meetings and product launches



Contact

High Tech Systems Park
Debbie Brands

Haaksbergerstraat 65
7554 PA Hengelo
T: +31 6 48 42 77 33
info@hightechsystemspark.com
hightechsystemspark.com

Kennispark Twente



Profile

The innovation campus Kennispark Twente in Enschede is one of the top 3 of most important science parks of The Netherlands.

It is a dynamic location, where over 480 companies work on developments and innovations that make a difference. It is a location with a hospitable and established climate for entrepreneurs, which provides development and growth opportunities for companies active in the high-tech sector with a strong focus on Medical Technology, Advanced Manufacturing, Chip Technology, Smart materials, Robotics, and AI & Smart IT. The campus is the second largest in the Netherlands in terms of commercial jobs, with 8,500 people working at Kennispark Twente in Enschede, excluding the 4,200 academic staff members at the University of Twente.



Infrastructure

Railway stations

- > Enschede Central
3 km - 15 min by bus
- > Enschede Kennispark
On campus

Airports

- > Münster-Osnabrück
87 km - 1 hr 30 min by car
- > Schiphol Amsterdam
170 km - 1 hr 35 by car / 2 hr 15 min by train

Motorway

- > A35
5 km - 5 min by car

Digital infrastructure

- > Fiber and Wi-Fi
- > Park fully broadband and Wi-Fi serviced

Enschede City Center

- > 5 min by train - 10 min by bus
- 10 min by car - 14 min by bicycle

Area

2,300,000 m²

Building capacity

> 400,000 m²

Development space

> 100,000 m²

Companies

480

Jobs

12,730

Students

12,019



Unique Companies

- > 3T
- > Bosch | ItoM
- > Bronkhorst High-Tech
- > Demcon
- > Ecare
- > Eurofins | MASER
- > Fraunhofer Innovation Platform
- > HoSt
- > LioniX International
- > Medspray | Resyca
- > Micronit
- > Movella | Xsens
- > Nobian
- > NX Filtration
- > Phix Photonics Assembly
- > Quix Quantum
- > Sigmax

Long-term Vision

Kennispark Twente is a knowledge-based campus with a unique mix of knowledge-intensive economic functions and academic networks, focusing on personal development, challenge and growth. Knowledge is a mainstay of the University of Twente, which is currently further strengthening its profile as an entrepreneurial university. We are transforming the area into a prime location where it is attractive to live and work for both (international) talent and companies, to become a go-to innovative breeding ground where research institutes, startups and high-tech businesses form the 'where science becomes business' ecosystem. Kennispark Twente aims to be a meeting point for top-class European knowledge, technology and innovative businesses.

Open Innovation Strategy

In Twente, sharing expertise and cooperative innovation speaks for itself. It springs from the conviction that this will lead to new possibilities, concepts and products. It helps companies to find their competitive advantage and to stay ahead of the competition. Innovating together means arriving at an intended result more quickly, and being able to focus on the demands and desires of the end-user and/or customer. At the end of the day, the metrics that really matter are shortening the time to market introduction and increasing profit on a particular product. Both companies and knowledge institutes in Twente play a strong role in this regard.

World-class Research Institutes

- > MESA+: One of the largest nanotechnology institutes in the world.
- > TechMed Centre: leading Innovation Hub impacting healthcare.



Fraunhofer Innovation Platform opened Advanced Manufacturing Center in 2023.



TechMed Center is leading Innovation Hub impacting healthcare.

- > DSI: contributes to responsible digitisation and the seamless integration of technology with people and their needs.
- > JICs: focus on photonic chips, medical technology (organ-on-a-chip) and digital systems for predicting maintenance of civil infrastructure.
- > CTIT: Institute for ICT research in context.
- > TPRC: Research Center for Advancing Thermoplastic Composites Technologies.
- > Fraunhofer Innovation Platform for Advanced Manufacturing: One of the largest non-profit organizations of applied research in Europe.
- > Max Planck: Center for Complex Fluid Dynamics.
- > Robotics Center: Use robotics to improve quality of life in every possible way.
- > European Membrane Institute: Performs confidential contract research directly with industry.

R&D Focus

The focus is on technological developments with a high social relevance: High Tech – Human Touch.

> Smart Materials

Thermoplastic composites, membranes, smart & functional materials, (bio)polymers, surface treatment.

> Software & Security

Sensors, embedded systems, architectures, ICT.

> Medical technology

Lab-on-a-chip (micro fluids), photonics, nano electronics.

> Chip Technology

Analogue chip design (a.o. RF, mixed signal), photonics, quantum, nano, packaging, equipment, micro-electronics

> Advanced manufacturing

Additive manufacturing, mechatronics & robotics, semiconductors.

These technological developments hold relevance in a number of domains where they may be applied, such as energy & battery, safety, health, water management and infrastructure.

Shared R&D Facilities

Kennispark Twente has several open innovation centers and platforms to develop and share knowledge related to high-tech systems and materials.

> High Tech Factory

Production facility for companies in micro- and nanotechnology.

> Thermoplastic Composites Research Center

Open innovation around thermoplastic composites.

> Fablab Enschede

Special equipment such as a 3D printer for prototyping.

> OICAM

Applied sustainable innovations in advanced materials.

> Pioneering

Platform for innovation in the construction industry.

> Design lab

Creative and cross-disciplinary lab connecting science and society.

> Virtual Reality & Smart Industry Lab

Equipped with the latest technology for visualisation, interaction, collaboration and communication.

> BMS LAB

A catalyst for high-quality, innovative research and societal challenges.

> Supersonic wind tunnel

For aerodynamic and aeroacoustic research.

Start-up Facilities and Programs

The business climate in Twente has traditionally been based on daring, a pioneering spirit and vision. The organization Novel-T is building an environment in which entrepreneurs can seize new opportunities to stay or become a frontrunner in their league. By connecting and activating talent, knowledge, capital, network and infrastructure, opportunities will lead to new, innovative businesses. Several facilities and programs are available to encourage those starting their own business:

- > TOP, START and GROW program: Tools and support through programs so entrepreneurs can continue to make an impact;
- > The Legal Advice Center offers advice on the legal aspects of starting a new business;



High Tech Factory: Production facility for companies in micro- and nanotechnology.

Kennispark Twente

- > There are options for a number of financing possibilities, such as the Innovation Fund Overijssel, istart.nl Seed Fund, Cottonwood, and a network of informal investors;
- > There is workspace available close to innovative companies;
- > Many events for sharing knowledge and skills on entrepreneurship are organized, such as the Start-up Fest, Create Tomorrow, InnovateGO and Campus Café.

Sustainability

Our policy

In addition to innovation, sustainability is one of the core criteria for every development on campus. Sustainability must lead to environmental and economic benefits. With its high-tech and research-related companies and institutions, Kennispark Twente is suitable for the application of innovative, sustainable solutions. It comprises a realistic laboratory where new techniques can be tested and implemented, including energy minimization, climate and ventilation, day lighting, green roofs, sustainable materials, etc. Sustainable real estate, common areas and events are used as a statement to make knowledge and solutions visible to the public.



Kennispark Twente invests in a vibrant and dynamic community.

BREAAM Certification

Kennispark Twente is a BREEAM-certified area. The sustainability efforts at Kennispark have been rewarded with a 2-star rating. The 2-star certificate is tangible proof of the various sustainability initiatives at Kennispark.

Kennispark Twente is one of the three main science parks in The Netherlands and set to grow further into a knowledge-based campus with a unique mix of knowledge-intensive economic functions and academic networks, focusing on personal development, challenge and growth.

The certificate is certainly not an end point, but rather a good incentive to make Kennispark Twente even more sustainable.

Our main objectives

- > Saving energy;
- > Making buildings more sustainable;
- > Installing solar panels on so many buildings;
- > Construct solar field over 2700 parking spaces + energy storage + charging facilities;
- > Research into sustainable heat and cold;
- > Research into a sustainable (process) water network;
- > Sustainable, separated, ZERO emission waste collection;
- > More space for water storage and measures against heat stress, attention to biodiversity;
- > Sustainable mobility (walking, cycling, public transport, car).



Remarkable sustainability objects/achievements

- > The Living Lab Smart Grid provides rich information about devices and building energy use as input for development and optimisation of new concepts, services and products for smart-grid solutions;
- > A heat exchange system (located in the pond) is in use.
- > Solar panels have been widely installed;
- > Plans for realisation of a solar field;
- > Plans for installation of a container battery.

Community Services & Facilities

Kennispark Twente offers:

- > The Gallery: The heart of a vibrant innovation ecosystem, where start-ups, scale-ups and growing companies work on groundbreaking technology and impact.
- > a full package of facilities, like Broodbode, Waaier, various restaurants, shops, meeting places, etc.;
- > a full program for all inhabitants (cultural, sports, business) and 250+ events annually for innovation & entrepreneurship, partner of Start-up Fest;
- > 2 hotels.

Leisure (sports, congress)

Soccerstadion FC Twente, movie theatre, sports facilities, cultural performances, ice skating area, concerts and exhibitions, conference facilities, hotel.

Parking

4,500 free parking spaces

Park management

- > Site-related services
Kennispark Twente is working with the Association for Kennispark Entrepreneurs on establishing park management. This will include issues such as energy, waste, safety, sustainability and parking.

> Building-related services

There are eight serviced incubators, all with facility management, reception, cleaning/waste services, copy & print facilities, etc. These are operated by various partners.

Governance

- > Campus ownership
Municipality of Enschede, University of Twente, private parties.
- > Decision makers & decision-making process
These include the municipality of Enschede, University of Twente, private parties and NFIA/Oost NL for initial contact with interested companies and contracts. Kennispark Twente conducts a profile assessment of any interested companies.
- > Management
Stichting Gebiedsorganisatie Kennispark.

Commitment

University of Twente, the municipality of Enschede, the Province of Overijssel, Twente Board and Saxion University of Applied Sciences.

Buildings

Education and Research	200,000 m ²
Company buildings	218,000 m ²
Housing (students)	2,470 units

By 2025, 117 student residences will have been completed on the campus of the University of Twente. In 2027, 183 homes will be added on the Business & Science Park for (young) professionals, PhD students and employees of Kennispark companies.



Contact

Kennispark Twente
Bertyl Lankhaar
Director

Hengelosestraat 500
7521 AN Enschede
T: +31 6 20 02 74 35
info@kennispark.nl | kennispark.nl

An aerial photograph of the Technology Base, showing a runway, taxiway, and various buildings and parking lots surrounded by green fields and trees.

Technology Base

Profile

Technology Base is situated on the former military airbase in green surroundings in the center of the triangle Enschede, Hengelo and Oldenzaal – and close to the German border. Technology Base is one of Twente's innovation hotspots. Together, we are helping to position Twente as a region with 'smart impact'. Technology Base is an experimentation hub for innovative companies who want to develop, test and simulate new concepts and ideas. The civil airport Twente Airport is situated on Technology Base. The organizations at Technology Base form part of an ecosystem of high-tech companies, academic institutions and public-sector organizations. It is an expansive site offering unlimited opportunities for testing manned and unmanned aircraft, autonomous systems and concepts related to advanced materials & manufacturing and safety & security.



Infrastructure

Railway stations

- > Enschede Central Station
8.7 km - 15 min by car - 26 min by bicycle
- > Hengelo Central Station
9 km - 15 min by car - 22 min by bicycle

Airports

- > Twente Airport
0 km - 0 min by car
- > Münster-Osnabrück
88 km - 1 hr by car
- > Schiphol
166 km - 1 hr 50 min by car - 2 hrs by train

Motorway

- > A1
2 km - 3 min by car

Digital infrastructure

- > Fiber, Wi-Fi and Park fully broadband

City Center

- > Enschede
9.9 km - 15 min by car - 26 min by bicycle
- > Hengelo
9.2 km - 15 min by car - 22 min by bicycle



Area
2,200,000 m²

Building capacity
124,000 m²

Development space
250,000 m²

Companies
24

Jobs
226

Students
56,420

Technology Base

Open Innovation Strategy

The site has various facilities for testing and training related to manned and unmanned aerial systems or concepts and scenarios related to safety & security. It also offers plenty of scope for prototyping, production trials and industrial research. The companies at Technology Base collaborate on the development of Technology Base in Twente in conjunction with the following strategic partners: University of Twente (UT), TPRC, Fraunhofer, Saxion University of Applied Sciences and ROC of Twente.

Technology base is the ideal location for businesses that are looking for a hub for development, testing, training and experimentation.

R&D Focus

Technology Base offers you the opportunity to develop and test your products or systems in the privacy of a secluded environment. The site comprises various indoor and outdoor areas for exercises and drills, training and scenario simulations. Technology Base is a unique location for performing high-risk activities. It gives you all the space you need for large-scale tests, training and simulations. Safety and security are guaranteed in the privacy of the secluded surroundings. The various types of outdoor spaces are used to test technology under extreme weather conditions, to test unmanned systems or to train large groups of people, for example.

Sustainability

The former F16 shelters include sustainable solutions for climate control and waste water. The heating system is based on an air-to-water heat pump. An on-site sewage facility (OSSF) has been installed to treat the waste water.

The OSSF purifies the waste water and then allows it to dissipate into the soil.

Shared R&D Facilities

Technology Base is a secluded area with various indoor and outdoor testing facilities where privacy, safety and security are guaranteed. It is the ideal location for business that are looking for a development, testing, training and pre-production site.

- > Various outdoor test areas;
- > 10,000m² of indoor test facilities available right next door;
- > Secluded environment;
- > 3 km-long runway.

Battery Safety Lab (Safety Center)

- > Living labs where smart ideas can be tried out in real life;
- > Opportunities to test experimental drones.



The Hangar Auditorium



Twente Safety Campus

Technology Base is an experimentation hub for innovative companies who want to develop, test and simulate new concepts and ideas.

Flexible office, meeting and event space

The former shelter B535 at Technology Base has been converted into a unique meeting, event and office location. Where the shelter previously served as accommodation for an F16, it has now been fully adapted to modern times and offers facilities for board meetings, training courses, events (up to 100 people) and office and flexi-work location.

Twente Airport: Living Lab for Sustainable Aviation

Twente Airport is part of Technology Base and the ideal and unique location for testing any new development or technology in future aviation. Its almost 3Km long runway, capacious airspace and secure facilities surrounding the airfield accommodate already several organizations in the field of transformational research in the aeronautical, defense and civil aviation sector.

Environment for testing

The airport's ambition is to grow and become an environment for testing of experimental and newly developed aircraft or procedures and related (digital) technology both in manned and unmanned applications such as eVTOL. In Addition, it hosts Business Aviation and provides a place for temporarily parking narrow body aircraft with parking maintenance. The absence of busy scheduled passenger traffic allows the management of the airport to rent its facilities out for testing, making it unique for its size in The Netherlands.

New devices and prototypes

Twente Airport is also home to several new aircraft and prototypes. It hosted a modified Pipistrel used by the foundation "Wings for Aid" that develop systems to drop relief goods in remote areas. The foundation performed many taxi and test flights at the airport. The aircraft is now being altered to prepare it for unmanned flights. Twente Airport also hosts high speed taxi and other tests for the PAL-V Liberty groundbreaking world's first flying car.

Unmanned and manned airspace integration

New drone techniques are being tested at the airport. In the long run manned and unmanned air travel will be integrated. Drone surveillance at the airport for both airfield and surrounding base illustrates nicely how far this technology is already common ground. Twente Airport is the front-runner in the Netherlands for the integration of unmanned and manned airspace.



Watertest PH-LAB NLR Twente Airport - Copyright Remco de Wit

TECHNOLOGY BASE BEYOND THE IMPOSSIBLE

Contact

Technology Base
Ton van Snellenberg, *Director*
Rosa Vos, *Project Secretary*

Vliegveldstraat 230
7524 PK Enschede
T: +31 53 480 00 90
info@technologybase.nl | technologybase.nl



XL Businesspark

Profile

XL Businesspark is one of the largest business parks in East Netherlands, strategically located along the A35 motorway and close to the German border. The park is designed for large-scale high-tech manufactures, logistics and sustainable energy solutions.



Area
180,000 m²

Building capacity
75,000 m²

Development space
20,000 m²

Companies
30

Jobs
2,500

Infrastructure

Railway stations

- > Almelo Central
6 km
- > Hengelo Central
16 km
- > Enschede Central
27 km

Airports

- > Münster-Osnabrück
100 km - 1 hr 10 min by car
- > Düsseldorf
160 km - 1 hr 40 min by car
- > Schiphol Amsterdam
150 km - 1 hr 40 min by car

Motorway

- > A35
0.5 km - 1 min by car
- > A1
3.5 km - 5 min by car

Digital infrastructure

- > Fiber

City Center

- > Almelo
10 min by car - 25 min by bicycle
- > Enschede
30 min by car

XL Businesspark

XL Businesspark benefits from the presence of leading high-tech suppliers such as VDL and Tecnotion, both key players in the supply chain of ASML. Their advanced expertise in precision engineering and motion control technologies strengthens the region's innovation ecosystem. This concentration of knowledge-intensive companies creates unique opportunities for collaboration, accelerates technological development, and positions XL Businesspark as a strategic location for businesses aiming to connect with the global semiconductor industry.

XL Businesspark is the strategic access point to XL Businesspark II, a future-oriented site dedicated to the innovative high-tech manufacturing industry. It will attract companies specializing in advanced engineering, precision components and sustainable technologies. Together, these parks form a dynamic ecosystem that strengthens Twente's ambition to grow into a green technology top region for industrial innovation and international competitiveness.

Ecosystem Next Tech Twente

XL Businesspark is recognized as a top work location within the Next Tech Twente ecosystem. This regional initiative connects leading companies, research institutes, and innovation hubs to accelerate technological development in areas such as chip technology and medical technology. Being part of Next Tech Twente strengthens the park's position as a magnet for talent, investment and cutting-edge projects.



XL Businesspark is recognized as a top work location within the Next Tech Twente ecosystem. This regional initiative connects leading companies, research institutes, and innovation hubs to accelerate technological development in areas such as chip technology and medical technology.

Long-term Vision

XL Businesspark Twente aims to evolve into the leading sustainable logistics and industrial hub in the eastern Netherlands, combining high-tech manufacturing with large-scale logistics and green energy innovation. The strategic goals include:

- > **Energy-Positive Operations**
Implementing renewable energy solutions such as solar and advanced storage systems (e.g., VDL Energy Systems) to achieve climate-neutral operations.
- > **Integration of Nature and Climate Resilience**
Maintaining and expanding ecological corridors like the Doorbraak and the water delta system to enhance biodiversity and manage water sustainably.
- > **Innovation Ecosystem**
Strengthening ties with high-tech companies (VDL, Tecnotion) and research institutes (Fraunhofer Innovation Platform, MESA+) to foster advanced manufacturing and energy transition projects.
- > **International Investment Magnet**
Positioning XL Businesspark as a gateway for global companies seeking sustainable growth and access to Europe's high-tech supply chains.

World-class Research Institutes

XL Businesspark benefits from its proximity to world-class research institutions such as the Fraunhofer Innovation Platform for Advanced Manufacturing and MESA+ Institute for Nanotechnology at the University of Twente. These institutes provide cutting-edge expertise in materials science, nanotechnology, and advanced manufacturing processes. Their presence fosters collaboration between industry and academia, accelerates technological breakthroughs, and strengthens the innovation ecosystem that supports high-tech manufacturing and sustainable solutions.

R&D Focus

- > Advanced Manufacturing in the semiconductor industry
- > Sustainable energy technology

Sustainability

XL Businesspark is a showcase for sustainable landscape design. The site incorporates an ecological corridor known as the “Doorbraak” and a dynamic water delta system. These features enhance biodiversity, support local flora and fauna, and contribute to climate resilience by managing water flow and creating green recreational spaces for employees and visitors.



De Doorbraak

XL Businesspark

Community Services & Facilities

Multimodal Accessibility

XL Businesspark Twente is multimodally accessible, ensuring seamless connectivity for businesses and employees. The site offers direct access to major motorways (A35 and A1), is connected to rail freight routes and is close to airports for international logistics. In addition, the park is located along a canal with its own loading and unloading quay, enabling efficient waterborne transport and strengthening its position as a top-tier logistics hub.

Parking

The site features a central parking facility while individual company buildings are equipped with ample on-site parking spaces to ensure convenience and efficiency.



Park management

XL Businesspark is reinforced by high-quality amenities that ensure safety, sustainability, and convenience for businesses and employees. Key features include:

- > Professional Park Management for smooth operations
- > 24/7 Camera Security for maximum safety
- > Central Firefighting Infrastructure to meet industrial standards
- > Landscape Services maintaining a green and attractive environment
- > EV Charging Points supporting sustainable mobility
- > Walking Routes for recreation and well-being

These facilities create a secure, sustainable, and pleasant working environment, making XL Businesspark an attractive location for leading companies.

Governance

The public space within XL Businesspark Twente is owned and managed by the Municipality of Almelo, ensuring high-quality infrastructure and maintenance. The company buildings are privately owned by investors and businesses, creating a dynamic mix of public governance and private enterprise that supports long-term development and investment security.



Contact

XL Businesspark
Dimitry Buter

T: +31 6 50 15 89 21

Zwolle Region

Zwolle Region

The Zwolle Region is an economic collaboration of 22 municipalities and 4 provinces (Overijssel, Gelderland, Flevoland, and Drenthe), working together with businesses, educational institutions, and societal organizations to address regional challenges.

Key sectors include Polymers, Agri-food, Advanced logistics, High Tech systems and materials and IT.

The region offers the ideal infrastructure for growth thanks to its excellent location from a logistics perspective and strong major sectors, reinforced by a good knowledge infrastructure. This makes Zwolle Region the place to be for innovative entrepreneurs, successful SMEs and independent professionals.

Science & Innovation Parks and Campuses in Zwolle Region

Food

The Green East, Raalte (15)

Tech

Smartzone Deventer, Deventer (6)

Innovation District Spoorzone Zwolle / Perron038 (13)

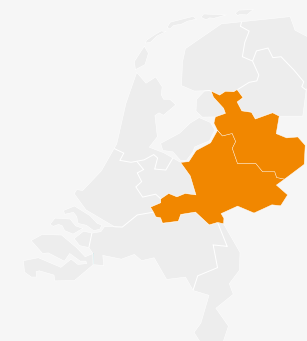



Innovation District Spoorzone Zwolle

Profile

Innovation District Spoorzone Zwolle is the beating heart of innovation in the Zwolle Region! Here, businesses, educational institutions, and talent join forces to create groundbreaking solutions. With four innovation hubs—focused on smart industries, creative industries, ICT/e-commerce, and smart sustainable living—we generate knowledge and technology that flow directly back into the region. A dynamic ecosystem where innovation thrives, strengthening businesses, creating opportunities for talent, and building a future-proof economy.



Infrastructure

Railway stations

- > Zwolle
0 km

Airports

- > Schiphol
122 km - 1 hr 15 min by car

Motorways

- > A28
3 km - 5 min by car

Digital infrastructure

- > Fiber, Wi-Fi and fully broadband

City Center

- > Zwolle
5 min by car - 5 min by bicycle



Area
1,000,000 m²

Innovation District Spoorzone Zwolle

Long-term Vision

Innovation District Spoorzone Zwolle is evolving into a vibrant area where work, living, learning, and leisure seamlessly converge. A dynamic ecosystem is taking shape here, where businesses, educational institutions, and talent collaborate on innovative solutions for the future. By forging smart connections between smart industries, creative industries, ICT/e-commerce, and smart sustainable living, the district fosters the development of knowledge and technologies that strengthen the entire region. With modern facilities, 4,000 new homes, and a strong focus on broad prosperity, it offers an inspiring environment where talent thrives, grows, and contributes to a sustainable, future-proof economy and society in the Zwolle Region.

Open Innovation Strategy

The open innovation strategy of Innovation District Spoorzone Zwolle revolves around collaboration and knowledge sharing between businesses, educational institutions, startups, and public organizations. The district serves as a dynamic ecosystem where diverse parties work together on innovative solutions to regional and societal challenges. By sharing facilities, expertise, and networks, barriers to innovation are eliminated, and cross-pollination between sectors is encouraged. The area provides an inspiring environment with access to state-of-the-art labs, testing facilities, and a vibrant program of events, workshops, and training sessions. With a strong focus on sustainable growth and talent development, it fosters a powerful connection between education and industry. This not only drives innovation within the district but also strengthens the entire region by sharing knowledge, attracting talent, and stimulating economic growth.



Part of Innovation District Spoorzone Zwolle (aerial view)

Excellent Research Institutes

- > University of Applied Science Windesheim
- > University of Twente

R&D Focus

The R&D focus of Innovation District Spoorzone Zwolle is built on the principle that collaboration drives better results. By jointly investing in high-cost technologies, such as advanced machinery and testing facilities, we lower the barriers to innovation and amplify its impact. This model encourages businesses, educational institutions, and startups to work together toward shared goals and interests. Sharing resources, knowledge, and expertise not only enhances individual performance but also

A dynamic ecosystem is taking shape here, where businesses, educational institutions, and talent collaborate on innovative solutions for the future.

strengthens broader regional development. This approach makes innovation more accessible, efficient, and effective, contributing to a future-proof and competitive Zwolle Region.

Shared R&D Facilities

Perron038, along with Biltin (Smart Sustainable Living Lab), Design Lab, and IT/E-commerce Lab.

Start-up Facilities

In addition to the innovation hubs, at least four dedicated facilities for start-ups will be established in the coming period. These spaces will provide the resources and support necessary for new businesses to thrive, further strengthening the ecosystem of Innovation District Spoorzone Zwolle.

Sustainability

The sustainability strategy of Innovation District Spoorzone Zwolle focuses on creating a future-proof ecosystem by driving innovation in energy transition, circular economy, and sustainable building materials, supported by hubs like Biltin. The district prioritizes smart solutions for mobility, energy, and land use, while fostering a sustainable living environment with 4,000 new homes and amenities. Collaboration between businesses, educational institutions, and startups integrates knowledge and resources, making sustainable innovations more accessible and impactful. This approach not only strengthens the region but also contributes to broad prosperity and a climate-friendly future for generations to come.

Community Services & Facilities

Innovation District Spoorzone Zwolle is located in the educational city of the Netherlands, home to 8 top-level higher education and vocational institutions. It offers modern office spaces, inspiring meeting venues, and co-working areas. Situated at the second-largest railway hub in the Netherlands, it provides a vibrant environment with diverse housing options, sports facilities, lively dining spots, and excellent mobility solutions. A dynamic hub where business growth, innovation, and connectivity take center stage for entrepreneurs and professionals.

Leisure

Innovation District Spoorzone Zwolle, in collaboration with Windesheim On Campus, offers a variety of sports facilities, diverse dining options, and is located just a few kilometers from four scenic natural areas: the Veluwe, Weerribben, Vechtdal, and Salland.

Parking

Parking is available in dedicated mobility hubs



Innovation District Spoorzone Zwolle

Site related services

The Innovation District Spoorzone Zwolle Foundation organizes and facilitates various events and activities in the area, including business and cultural events, community building initiatives, and identifying collaboration opportunities. Additionally, it is responsible for the branding and placemaking of the district.

Building related services

Available in various office and work locations.

Governance

A combination of municipal and private ownership, with development primarily driven by the regional business community.

Commitment & support

A wide variety of businesses, ranging from small to large and operating on both regional and international levels.

Education and Research buildings

Research institutions such as Windesheim Campus and innovation hubs like Biltin, Creative Works, Digital District Zwolle, and Perron038.

Housing (students)

Already available, but set for significant expansion in the near future.



Perron038

Perron038 is one of the great examples of innovation hubs in Spoorzone Zwolle. It's the place to be for innovative manufacturing in the east of The Netherlands. At Perron038 we work together on the future of the high-tech manufacturing industry. Technicians and students get inspired, work together and research and experiment, in order to discover technological innovation. This is done by continuously innovating, learning and inspiring. We produce the future together.

Open Innovation Strategy

Businesses partner into Perron038, to conduct R&D-projects within the innovation center. They conduct R&D-projects together with students of the University of Windesheim. And R&D-projects together with other Perron038-partners. R&D refers to applied research and development projects for the mechanical engineering and manufacturing industries.

R&D Focus

Applied research and development for the mechanical engineering and manufacturing industries. With a focus on additive manufacturing in metal, robotics for assembly, vision and optics, digital manufacturing and AI.

Shared R&D Facilities

Factory NEXT labs, with labs on the topics of:

- > Additive manufacturing
- > Digital manufacturing
- > Vision & optics
- > Robotics & logistics
- > AI
- > Predictive maintenance

Biltin

Since August 2025, the innovation hub Biltin has continued its activities at a new location in Spoorzone Zwolle. At this location, companies, research partners and students collaborate on sustainable and data-driven innovations that contribute to a CO₂-neutral built environment.



Contact

Innovation District Spoorzone Zwolle
Marius Woldberg
Managing Director of the Innovation District Spoorzone
Zwolle Foundation

Hanzelaan 95B
8017 JE Zwolle
T: +31 38 202 21 87
info@spoorzonezwolle.nl | spoorzonezwolle.nl



Contact

Perron038
Sjoerd Keijser
Managing Director

Hanzelaan 95B
8017 JE Zwolle
T: +31 38 202 20 10
info@perron038.nl | perron038.nl

Factory NEXT labs at Perron038

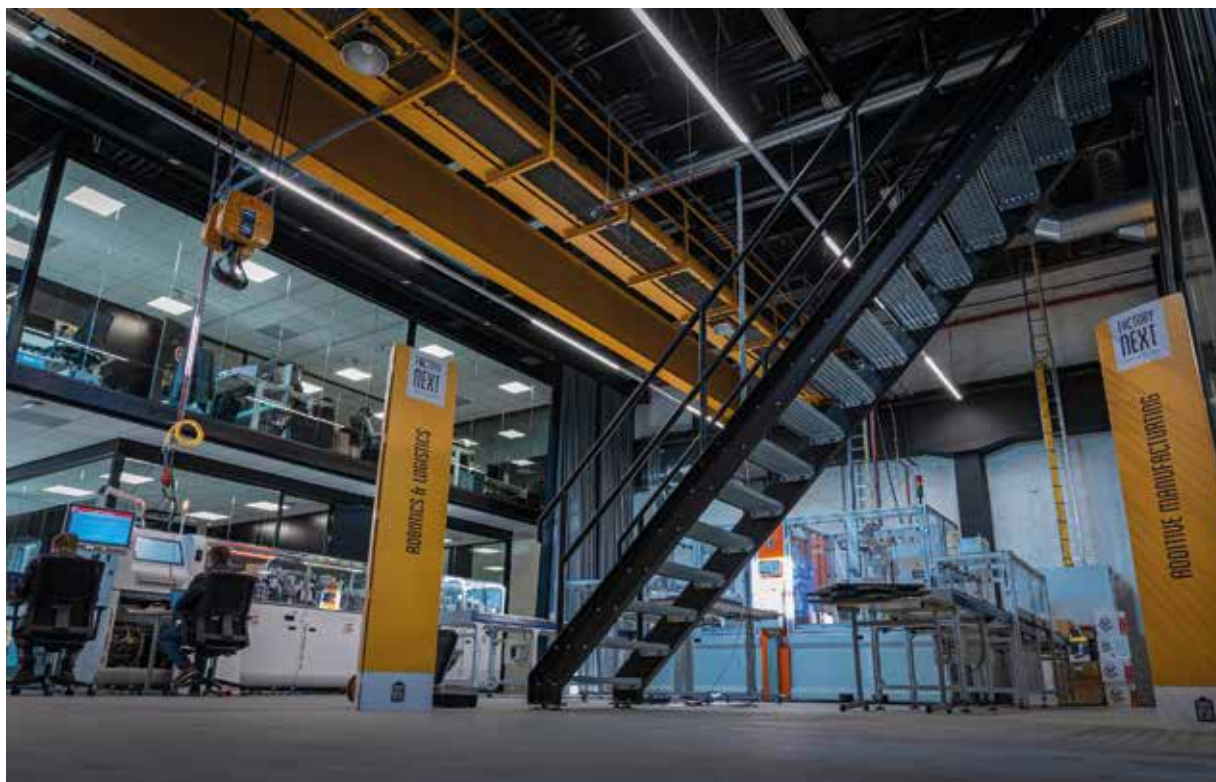

A photograph of a modern urban park. In the foreground, there is a grassy area with tall reeds and flowers. A pond is in the middle ground, with a small boat and people. In the background, there are modern buildings and more trees. The sky is overcast.

Smartzone Deventer

Profile

The catalyst behind Smartzone Deventer is formed by Knowledge Campus De Kien and the Business Innovation Campus De Gasfabriek. In this Smartzone, knowledge development, innovation, and entrepreneurship reinforce one another, leading to a powerful acceleration toward a future-proof living and working environment. The themes core range — from the energy transition and mobility to development and housing — and have an impact on the city, the region, and society as a whole.

Infrastructure

Railway stations

- > Deventer
0 km
- > Utrecht
85 km

Airport

- > Schiphol
120 km

Motorway

- > A1
<5 min by car

Digital infrastructure

- > Fiber, Wi-Fi and fully broadband

City Center

- > Deventer: 5 min by bus - 5 min by car -
5-10 min by bicycle



Area

220,000 m²

Building capacity

125,000 m²

Development space

20,000 m²

Students

>8,000

Smartzone Deventer

The two interconnected and mutually reinforcing campus developments within Smartzone Deventer are:

- > **Knowledge Campus De Kien** – the knowledge hub with major knowledge institutions where students, researchers, and companies collaborate on digital technologies for the living environment. This is where innovative solutions emerge for challenges such as heat stress, grid congestion, mobility, and housing shortages.
- > **Business Innovation Campus De Gasfabriek** – the incubator for now more than 75 start-ups and scale-ups that translate knowledge into scalable IT and technological applications for sectors such as logistics, education, healthcare, and energy.

Long-term Vision

Deventer is a knowledge-intensive city and holds a central position in the innovative landscape of Eastern Netherlands. It is a place where digitalization, technology, knowledge, and entrepreneurship come together to make our living environment future-proof. In the urban Smartzone, learning, working, and living blend seamlessly. Innovation takes shape here in practical applications – such as sustainable energy, smart mobility, and new forms of housing. Professionals and students from business, education, and government join forces to develop smart solutions for societal challenges.

By 2040, Deventer will be a city of renewal and connection, a pleasant place to live and an inspiring place to do business and grow: from start-up to multinational, and from student to professional.

Open Innovation Strategy

Deventer opts for an open innovation strategy in which knowledge sharing, collaboration, and experimentation take center stage – for example through knowledge communities, network circuits, and business events.

The immediate surroundings of De Kien – the Spoorzone – function as a living lab for data-driven experiments. Here, new technological solutions are tested for urban and societal challenges, generating insights that can be applied elsewhere. De Kien is designed in such a way that partners from both within and outside the region can easily join to learn, innovate, and share knowledge together.

The Business & Innovation Campus De Gasfabriek is an ecosystem that strengthens Deventer's powerful start-up economy. This is where companies grow with the support of advice, networks, and financing – all within an environment where living, working, and leisure come together.

World-class Research Institutes

Deventer forms a strong knowledge region with leading educational and research institutions. Saxion and Aventus are firmly rooted here and work together with businesses and government on applied research and innovation. In addition, there are connections with several universities.



Within specific research programs, such as Grounded, partners like Deltares and The Hague University of Applied Sciences collaborate on sensing and digitalizing the subsurface. In this way, a world-class network emerges in which research directly contributes to sustainable and smart solutions for the living environment.

R&D Focus

Knowledge only gains real value when it can be applied. Smartzone Deventer functions as a public playground for experimentation: a living lab where we learn and innovate for smart and sustainable urban development.

Knowledge Campus De Kien focuses on digital solutions for urban challenges such as heat stress, grid congestion, and housing shortages, in collaboration with Saxion, Topicus, Witteveen+Bos, and the Municipality of Deventer.

BIC De Gasfabriek concentrates on digital transformation across all sectors, organizes hundreds of business events each year, and supports start-ups and scale-ups with technology experiments that create impact. This takes place through the BIC-LAB and the Deventer Development Quarter (DOK).

Shared R&D Facilities

De Kien and BIC share numerous R&D facilities where innovative practical applications are tested. In Deventer we offer:

- > AI computer with enormous computing power
- > Internet of Things Lab, including through the Data & AI Lab
- > Prototyping lab with 3D printers, laser cutters, and more
- > Practical labs, such as the BIC-LAB, Scent Lab, Sensor Lab, Human Behavior Lab, and Nano-Forensics Lab
- > Field labs: Move & Mobility Lab, Water-Soil-Green Lab



Smartzone Deventer

Start-up Facilities

In our Smartzone, start-ups are given space and support — from and for businesses of all sizes. The learning communities offer knowledge, inspiration, and exchange opportunities for students and (starting) entrepreneurs. Partner organizations provide a credit-pass system that allows entrepreneurs to access specialized expertise. Business coaches, pleasant workspaces, and access to funds and investors are available. This also includes the DOK (with a regional function for SMEs), the clubhouse for entrepreneurial Deventer. The Saxion Centre for Entrepreneurship offers a wide range of support.

Sustainability

Sustainability is an important part of the campus approach and the way we work — as biobased, circular, and demountable as possible. For example, we are adding extra floors to apartment buildings and transforming vacant offices into residential units. Knowledge development takes place at De Kien, while De Gasfabriek serves as a testing ground for sustainable innovations. For “building X,” straw-filled biobased materials were used, and “building Y” was constructed to be almost entirely demountable. With the idea of creating a “Gas-Free Gasfabriek,” we follow the trias energetica principle, focusing on increasing thermal resistance.

For the Fittershuis building, an environmental permit has been requested, combining reuse of existing structures with circular and biobased material use.

In the Smartzone Deventer, knowledge development, innovation, and entrepreneurship reinforce one another, leading to a powerful acceleration toward a future-proof living and working environment.



Community Services & Facilities

The activities within the Smartzone are open to companies and professionals from Deventer and the wider region. A new dynamic has emerged around lifelong learning for everyone working in Tech and ICT. The Smartzone is already developing into an attractive location for engineering firms, high-tech companies, and ICT businesses.

With the addition of new housing, research facilities, and office spaces — combined with excellent accessibility and shared amenities — its appeal as a business location continues to grow.

De Kien is located directly next to the train station, while BIC is optimally accessible via the A1 and A50. There is ample parking and a variety of shared mobility options.



Leisure

The campus areas offer a versatile mix of opportunities: from events to sports and recreational activities. Deventer itself has much to offer as well, such as the largest knowledge festival in the Netherlands, a rich cultural scene, sports facilities, and vibrant shopping districts. In and around the Smartzone, you can enjoy the historic city centre, the city park, the river IJssel, and the theatre — all within easy reach.

Ownership structure & commitment

De Gasfabriek is a limited partnership (CV) with 6 partners. Knowledge Campus De Kien is a collaboration governed by the lead representatives of 7 founding fathers from business, education, and government. Day-to-day operations are centrally coordinated by a core team from the Kien Knowledge Lab.



Contact

René Nelissen (Knowledge Campus De Kien manager)
Verzetslaan 20
7411 HX Deventer
T: +31 6 10 95 36 14
info@dekien.nl | dekien.nl

Paul Blankhorst (Business Innovation Campus
De Gasfabriek manager)
Zutphenseweg 6B
7418 AJ Deventer
T: +31 6 12 58 40 68
info@degasfabriek.com | degasfabriek.com

The Green East



Profile

The Green East is the place where sustainable ideas come to life and grow into impactful innovations. We provide space, facilities, and an inspiring environment to enable the transition to a circular and future-proof society. Visionaries and pioneers have the opportunity here to develop essential technologies and forge collaborations. Whether you are working on food innovation, Biobased building, or other green solutions: we are here for everyone seeking a solid foundation to experiment, learn, and grow. Together, we create an ecosystem where sustainability is the standard.

Overzicht gebouwen en functies

1. Bedrijfswooning
2. Bijgebouw
3. Kantoor / Laboratorium / Kas
4. Bedrijfsgebouw
5. Pilot fabriek
6. Oude varkensschuur (geen functie)
7. Oude varkensschuur (tijdelijke woonfunctie)
8. Werktuigen berging

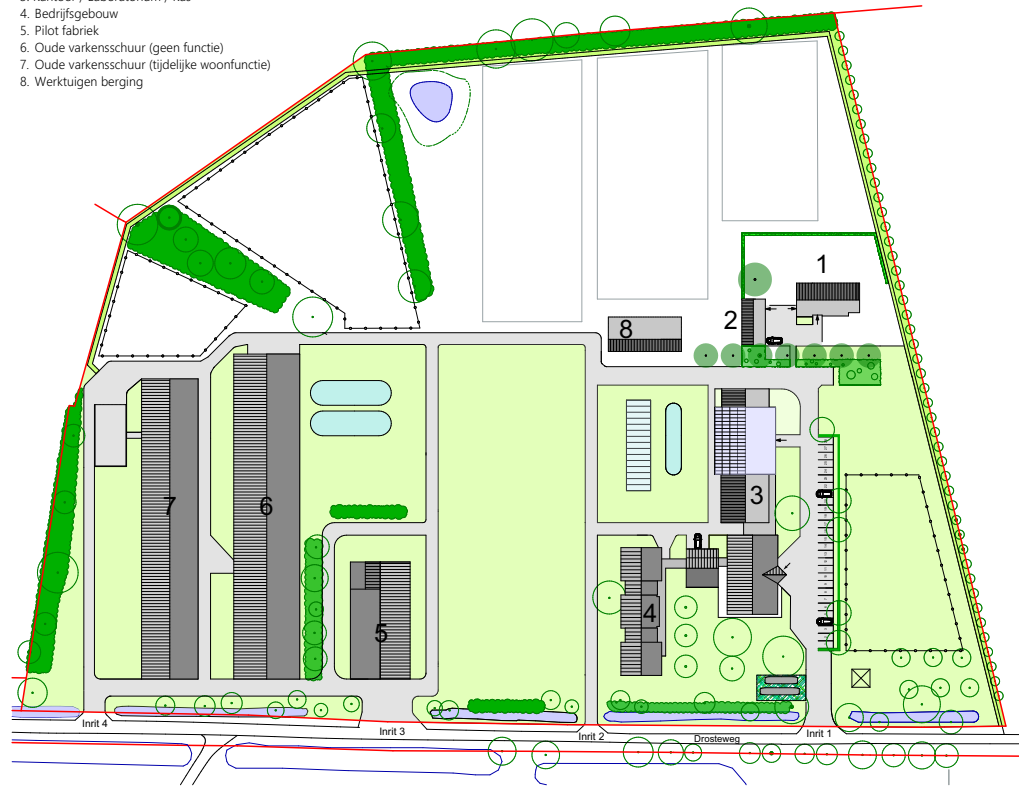

Area

60,000 m²

Building capacity

2,500 m²

Development Space

2,000 m²

Companies

6

Jobs

45

The Green East Raalte

The Green East

Infrastructure

Railway stations

- > Raalte
4 km - 25 min by bus
- > Deventer
14 km - 41 min by bus

Airports

- > Schiphol Airport
102 km - 1 hr 30 min by car
- > Eindhoven
142 km - 1 hr 40 min by car
- > Münster-Osnabrück
128 km - 1 hr 40 min by car
- > Düsseldorf
175 km - 2 hr by car

Motorway

- > A1
15 km - 25 min by car
- > A28
19 km - 25 min by car

Digital infrastructure

- > Fiber, WI-FI and fully broadband

City Center

- > Deventer: 41 min by bus - 19 min by car - 53 min by bicycle
- > Zwolle: 54 min by train - 29 min by car - 76 min by bicycle



The Green East

Long-term Vision

The Green East aims to become the leading innovation ecosystem in East Netherlands, with a strong focus on three key transitions: protein transition, biobased construction, and biopolymers. We envision a future where companies, knowledge institutions, and startups collaborate to develop solutions that contribute to a circular economy and a climate-resilient society. By providing state-of-the-art facilities, shared knowledge, and a strong community, we create an environment where experimentation, scaling, and impact are central. The Green East is not just a physical location, but a movement that attracts businesses to shape a green future together.

Open Innovation Strategy

At The Green East, we believe collaboration is the key to sustainable progress. Our open innovation strategy focuses on connecting companies, knowledge institutions, and startups around three core themes: protein transition, biobased construction, and biopolymers. We foster an



ecosystem where ideas flow freely, knowledge is shared, and partners co-create solutions to address major societal challenges. By offering shared facilities, testing environments, and networking opportunities, we accelerate the journey from concept to market. Transparency, trust, and shared value are at the heart of our approach. This strategy not only drives the development of innovative products and processes, but also builds strong partnerships that contribute to a circular and climate-resilient future. The Green East is the place where open innovation becomes reality.

R&D Focus

Our facilities provide space for pilot projects, product development, and the scaling of circular solutions. The goal is to create practical applications that contribute to a circular economy. Through collaboration and co-creation, we are turning East Netherlands into a breeding ground for groundbreaking technologies and sustainable business models.

The Green East is the place where sustainable ideas come to life and grow into impactful innovations.



Shared R&D Facilities

Food Innovation Hub – Focused on the development and scaling of sustainable food concepts, with special attention to the protein transition. Here, companies can experiment with new ingredients, product development, and process optimization in an FSSC 22000 certified environment.

Start-up Facilities

The Green East provides facilities to support young companies and startups. We primarily offer access to high-quality facilities and a broad network of experts, entrepreneurs, and knowledge institutions. This network helps address challenges and find collaboration opportunities. Our goal is to give startups a solid foundation to turn ideas into market-ready solutions.

Sustainability

The Green East has sustainability as its core value and focuses on accelerating the transition to a circular economy. Our policy is based on providing facilities and an ecosystem in which companies, knowledge institutions and start-ups work together on innovative solutions. We encourage projects that contribute to less waste, more efficient use of raw materials and the development of sustainable products and processes.



Community Services & Facilities

The Green East offers an inspiring environment with shared workspaces, meeting facilities, and high-quality R&D resources. Companies and startups gain access to a broad network of experts and entrepreneurs, as well as support for innovation projects. Together, we create a dynamic community focused on collaboration, knowledge exchange, and sustainable growth.

Leisure

The Green East offers a green and inspiring environment where relaxation is key. There are walking trails and outdoor spaces to enjoy nature and tranquility.

Parking

The Green East offers ample parking directly on-site. Free parking spaces are available for visitors, tenants, and employees. In addition, there is sufficient space for bicycles and electric vehicles, including charging points for EVs.

Park management

- > Site-related services:
 - > Space for events, workshops, and network meetings
 - > Waste separation and recycling
 - > Free on-site parking
 - > Charging stations for electric vehicles
- > Building-related services:
 - > Access control & security
 - > Cleaning & maintenance
 - > Climate control & energy supply
 - > Internet & IT infrastructure



Contact

The Green East
Rudy Horstman
Manager

Drosteweg 8
8101 NB Raalte
T: +31 6 51 68 99 96
Info@thegreeneast.nl | thegreeneast.nl

East Netherlands Development Agency (Oost NL)

Laan van Malkenschoten 40

7333 NP Apeldoorn

P.O. Box 1026

7301 BG Apeldoorn

The Netherlands

Contact

Susan van Boxtel

team manager

Foreign Direct Investment

+31 6 18 41 67 45

susan.vanboxtel@oostnl.nl



Fons de Zeeuw

director International

+31 6 12 14 09 35

fons.dezeeuw@oostnl.nl



**East Netherlands
Development Agency**

